



Known for excellence.
Built on trust.

GEOTECHNICAL
ENVIRONMENTAL
ECOLOGICAL
WATER
CONSTRUCTION
MANAGEMENT

5 Commerce Park North
Suite 201
Bedford, NH 03110
T: 603.623.3600
F: 603.624.9463
www.gza.com



April 5, 2021
File No. 04.0190999.40

NHDES Wetlands Bureau
29 Hazen Drive, P.O. Box 95
Concord, New Hampshire 03302

Re: Statutory Permit-by-Notification (SPN)
367 Transmission Line Right-of-Way (ROW)
Milford, New Hampshire

Dear Wetlands Inspector:

This letter transmits a Statutory Permit-by-Notification (SPN) application on behalf of Public Service of New Hampshire doing business as Eversource Energy (Eversource), for proposed maintenance work located within the existing and maintained 367 Transmission Line ROW. GZA GeoEnvironmental, Inc. (GZA) has been retained by Eversource Energy to pursue state permitting for maintenance of the utility structures (i.e., utility poles) located within the 367 Transmission Line ROW which crosses through a portion of Milford, New Hampshire.

In the Town of Milford, Eversource Energy is proposing to replace one utility structure. The maintenance work requires temporary wetland impacts for work pad placement and associated access.

Pursuant to RSA 482-A:3; XV(d), Eversource has submitted a one-time annual fee of \$400 per town, in order to cover Notifications during 2021. Therefore, a new fee has not been included with this submittal.

Thank you for your review. Please feel free to contact Lindsey White at (603) 232-8753 if you have any questions or comments.

Very truly yours,

GZA GEOENVIRONMENTAL, INC.

Lindsey White
Lindsey White, WSA, SSA
Project Manager

Tracy Tart
Tracy Tart, CWS, CESSWI
Associate Principal

LEW/TLT



Attachments: Statutory Permit-by-Notification (SPN) Form
NHB Report
Site Locus
Annotated Plan

cc: Jeremy Fennell, Eversource
Town of Milford, Town Clerk



**UTILITY MAINTENANCE ACTIVITY
STATUTORY PERMIT-BY-NOTIFICATION (SPN)
Water Division/Land Resources Management
Wetlands Bureau**
[Check the Status of your Notification](#)



RSA/Rule: RSA 482-A / Env-Wt 308.04(d); Env-Wt 521

NAME OF UTILITY PROVIDER: Eversource Energy

	Administrative Use Only	<input type="checkbox"/> SPN complete and project as described conforms with all applicable requirements.	
		<input type="checkbox"/> SPN incomplete and/or project as described does not conform with all applicable requirements.	
		File No.:	Reviewer's Initials:
		Check No.:	Amount:

Terms in **bold font** are defined in the attached "Definition of Terms" page.

SECTION 1 - PROJECT CRITERIA	
a. Does the project meet all applicable Best Management Practices for Utility Maintenance (<u>Utility BMPs</u>) and have temporary impacts associated with inspection, maintenance, repair, replacement, or removal of existing utility facilities only within existing rights-of-way (Env-Wt 521.06(a)(1))?	<input checked="" type="checkbox"/> Yes <input type="checkbox"/> No
b. If there will be impacts to any Priority Resource Area (PRA) , other than designated prime wetlands and their duly-established 100-foot buffers , will the project follow recommendations provided by Natural Heritage Bureau (NHB), New Hampshire Fish and Game Department (NHF&G), and the Department (Env-Wt 521.06(a)(4))?	<input checked="" type="checkbox"/> Yes <input type="checkbox"/> No <input type="checkbox"/> N/A
If you answered "No" to question 1a and/or 1b, you cannot use this form and must file a Standard Permit Application (RSA 482-A:3, XV). If you answered "Yes" to question 1a and 1b, proceed to question 1c.	
c. Will the project include establishing new access roads, installing permanent stream or wetland crossings, constructing new utility corridors or rights of way (ROW), or establishing new utility assets within existing corridors or rights of way (Env-Wt 521.06(a)(2))?	<input type="checkbox"/> Yes <input checked="" type="checkbox"/> No
d. Will the project include any permanent fill in navigable waters (Env-Wt 521.06(a)(3))?	<input type="checkbox"/> Yes <input checked="" type="checkbox"/> No
e. Will timber mats be: <ol style="list-style-type: none"> 1. Used in a tidal marsh; or 2. Used in an area other than a tidal marsh if they are: <ul style="list-style-type: none"> • Not necessary to conduct activities; • Not removed as soon as work is completed; or • In place longer than one growing season (Env-Wt 521.06(a)(5))? 	<input type="checkbox"/> Yes <input checked="" type="checkbox"/> No
f. Will the project cause permanent conversion of more than 3,000 SF of forested wetlands to emergent or scrub-shrub wetlands with or without temporary fill (Env-Wt 521.06(a)(6))?	<input type="checkbox"/> Yes <input checked="" type="checkbox"/> No
If you answered "Yes" to questions 1c, d, e, and/or f, you cannot use this form and must file a Standard Permit Application (RSA 482-A:3, XV). If you answered "No" to all of the questions 1c-1f, continue to Section 2.	

irm@des.nh.gov or (603) 271-2147
 NHDES Wetlands Bureau, 29 Hazen Drive, PO Box 95, Concord, NH 03302-0095
www.des.nh.gov

SECTION 2 - PROPOSED PROJECT DESCRIPTION (RSA 482-A:3, XV(b)(2))

Please provide a brief written description of the nature of the work to be conducted.

Eversource Energy is proposing to complete maintenance work on the 367 Transmission Line which crosses through a portion of Milford, New Hampshire. In the Town of Milford, Eversource Energy is proposing to replace one utility structure. The maintenance work requires temporary wetland impacts for work pad placement and access to associated structures.

SECTION 3 - LOCATION OF PROPOSED ACTIVITY (RSA 482-A:3, XV(b)(3))

Town/City: Milford

SECTION 4 - PROJECT TYPE (RSA 482-A:3, XV(b)(2))

Check all that apply:

- | | |
|---|---|
| <input checked="" type="checkbox"/> Equipment repair and maintenance in ROW | <input type="checkbox"/> Natural Gas Lines |
| <input type="checkbox"/> Overhead Electric Lines | <input type="checkbox"/> Water Supply Lines |
| <input type="checkbox"/> Overhead Telephone or Cable Lines | <input type="checkbox"/> Sewer Lines |
| <input type="checkbox"/> Vegetative maintenance within ROW
(If access through private property is needed to reach the ROW, permission from the landowner(s) is required prior to conducting work.) | <input type="checkbox"/> Other: _____ |

SECTION 5 - UTILITY PROVIDER (RSA 482-A:3, XV(b)(1))

UTILITY PROVIDER/COMPANY NAME: Eversource Energy

AUTHORIZED REPRESENTATIVE LAST NAME, FIRST NAME, M.I.: Fennell, Jeremy

MAILING ADDRESS: 13 Legends Drive

TOWN/CITY: Hooksett

STATE: NH

ZIP CODE: 03106

SECTION 6 - IMPACTED RESOURCES (RSA 482-A:3, XV(b)(2))

Check all that apply.

- Temporary Non-Tidal Wetland
- Temporary Intermittent Stream Crossing
- Temporary (2-years maximum) Perennial Stream or River Crossing

SECTION 7 - ATTACHMENTS (RSA 482-A:3, XV)

Verify the following attachments are submitted with this form by checking each box below.

- United States Geological Survey (USGS) Topographic Map** (at its original scale 1:24,000 or 1:25,000) with the project location(s) or utility corridor clearly identified (RSA 482-A:3, XV(b)(3)).

irm@des.nh.gov or (603) 271-2147

NHDES Wetlands Bureau, 29 Hazen Drive, PO Box 95, Concord, NH 03302-0095

www.des.nh.gov

The most recent National Wetland Inventory (NWI) map, **USGS topographic map**, or annotated aerial photograph showing wetland types crossed. See NHDES Wetland Permit Planning Tool (Env-Wt 406.03(b)(2)c.(5)).

\$400 non-refundable filing fee per town, per year. Please make check or money order payable to: Treasurer - State of NH (RSA 482-A:3, XV(d)).

The **DataCheck** identification number and an affirmation that recommendations have been received (Env-Wt 308.05(a)(2)).

Natural Heritage Bureau Identification ID: NHB 21 - 0652

Questions related to completing this process should be directed to the Natural Heritage Bureau.

SECTION 8 - REQUIRED CERTIFICATIONS FROM AUTHORIZED UTILITY PROVIDER REPRESENTATIVE

By initialing each item and signing this application, the authorized representative affirms that (Env-Wt 308.05(b)(2)):

Initials: JF The project is not located in a PRA, except as provided in Env-Wt 407 and Env-Wt 521 where the applicant has met with the resource agencies (NHB, NHF&G, and NHDES) in a pre-notice meeting.

Initials: JF All recommendations of NHB and NHF&G have been received. And

Initials: JF The person responsible for the activity is aware of the limits of the SPN and applicable BMPs for the project, and will adhere to both.

By initialing each item and signing this application, the authorized representative certifies that (Env-Wt 311.11(e)):

Initials: JF The information submitted on or within this notification is true, complete, and not misleading to the best of the signer's knowledge and belief. And

Initials: JF The signer understands that:

- The submission of false, incomplete, or misleading information constitutes grounds for NHDES to:
 1. Deny the application.
 2. Revoke any approval that is granted based on the information. And
 3. If the signer is a certified wetland scientist, licensed surveyor, or professional engineer licensed to practice in New Hampshire, refer the matter to the joint board of licensure and certification established by RSA 310-A:1.
- The signer is subject to the penalties specified in New Hampshire law for falsification in official matters, currently RSA 641. The signature shall constitute authorization for the municipal conservation commission and the Department to inspect the site of the proposed project.

SECTION 9 - REQUIRED SIGNATURE FROM AUTHORIZED UTILITY PROVIDER REPRESENTATIVE

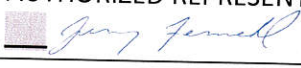
AUTHORIZED REPRESENTATIVE SIGNATURE: 	PRINT NAME LEGIBLY: Jeremy Fennell	DATE: 4/5/2021
--	---------------------------------------	-------------------

New Hampshire Natural Heritage Bureau
NHB DataCheck Results Letter

To: Nyssa Seekamp
5 Commerce Park North
Bedford, NH 03110

From: NH Natural Heritage Bureau

Date: 2/24/2021 (This letter is valid through 2/24/2022)

Re: Review by NH Natural Heritage Bureau of request dated 2/24/2021

Permit Types: Utility Statutory Permit by Notification (SPN)
Stormwater Pollution Prevention

NHB ID: NHB21-0652

Applicant: Nyssa Seekamp

Location: Milford
Tax Map: Multiple, Tax Lot: Multiple
Address: Eversource Energy Right-of-Way

Proj. Description: Eversource Energy is proposing to replace existing utility poles on the 367
Transmission Line.

The NH Natural Heritage database has been checked for records of rare species and exemplary natural communities near the area mapped below. The species considered include those listed as Threatened or Endangered by either the state of New Hampshire or the federal government. We currently have no recorded occurrences for sensitive species near this project area.

A negative result (no record in our database) does not mean that a sensitive species is not present. Our data can only tell you of known occurrences, based on information gathered by qualified biologists and reported to our office. However, many areas have never been surveyed, or have only been surveyed for certain species. An on-site survey would provide better information on what species and communities are indeed present.

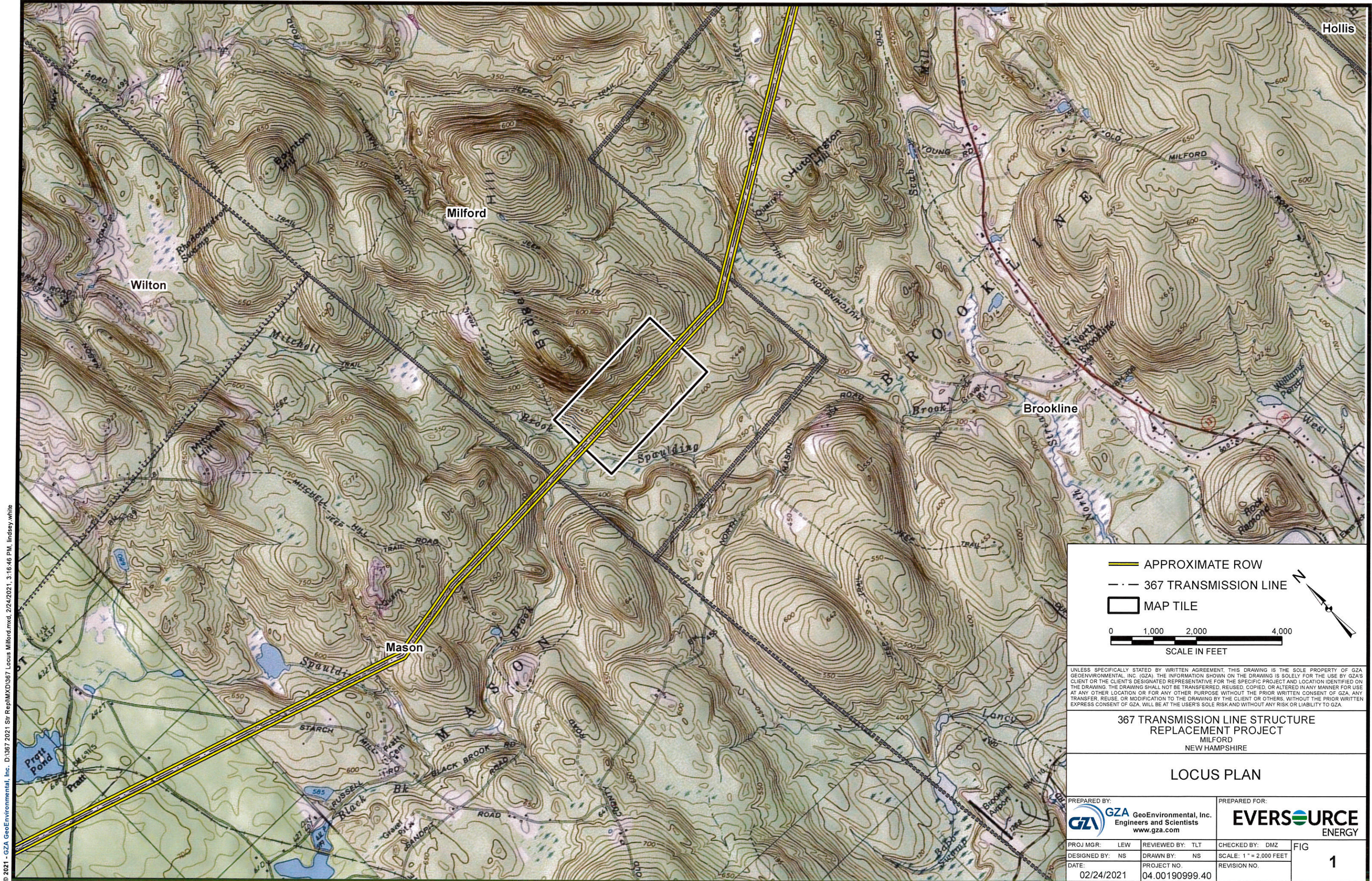

© 2021 - GZA GeoEnvironmental, Inc. D:\367 2021 Str Repl\MXD\367 Locus Milford.mxd, 2/24/2021, 3:16:46 PM, lindsey.white

— APPROXIMATE ROW
- - - 367 TRANSMISSION LINE
 MAP TILE

0 1,000 2,000 4,000
 SCALE IN FEET

UNLESS SPECIFICALLY STATED BY WRITTEN AGREEMENT, THIS DRAWING IS THE SOLE PROPERTY OF GZA GEOENVIRONMENTAL, INC. (GZA). THE INFORMATION SHOWN ON THE DRAWING IS SOLELY FOR THE USE BY GZA'S CLIENT OR THE CLIENT'S DESIGNATED REPRESENTATIVE FOR THE SPECIFIC PROJECT AND LOCATION IDENTIFIED ON THE DRAWING. THE DRAWING SHALL NOT BE TRANSFERRED, REUSED, COPIED, OR ALTERED IN ANY MANNER FOR USE AT ANY OTHER LOCATION OR FOR ANY OTHER PURPOSE WITHOUT THE PRIOR WRITTEN CONSENT OF GZA. ANY TRANSFER, REUSE, OR MODIFICATION TO THE DRAWING BY THE CLIENT OR OTHERS, WITHOUT THE PRIOR WRITTEN EXPRESS CONSENT OF GZA, WILL BE AT THE USER'S SOLE RISK AND WITHOUT ANY RISK OR LIABILITY TO GZA.

**367 TRANSMISSION LINE STRUCTURE
 REPLACEMENT PROJECT**
 MILFORD
 NEW HAMPSHIRE

LOCUS PLAN

PREPARED BY: GZA GeoEnvironmental, Inc. Engineers and Scientists www.gza.com		PREPARED FOR: EVERSOURCE ENERGY	
PROJ MGR: LEW DESIGNED BY: NS DATE: 02/24/2021	REVIEWED BY: TLT DRAWN BY: NS PROJECT NO.: 04.00190999.40	CHECKED BY: DMZ SCALE: 1" = 2,000 FEET REVISION NO.:	1

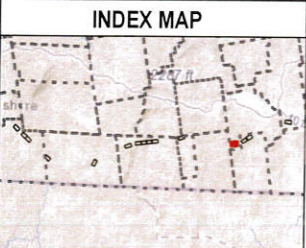

- EXISTING STRUCTURE
- STRUCTURE TO BE REPLACED
- NHDOT ROADS
- LIMIT OF WORK AREA
- APPROXIMATE ROW
- 367 TRANSMISSION LINE
- DELINEATED INTERMITTENT STREAM
- NON DELINEATED FLOWLINE
- DELINEATED PERENNIAL STREAMS
- WETLAND ADJACENT TO T3+ STREAM
- PEATLAND
- TOWN BOUNDARY
- FIELD DELINEATED WETLAND BOUNDARIES
- MAP SHEET MATCHLINE
- FIELD DELINEATED WETLANDS

This mapping product has been created to comply with submittal requirements to obtain certain regulatory approvals and, as such, there is no reliance on the information contained herein for any other purpose.



NO.	DATE	REVISIONS

EVERSOURCE ENERGY	
367 Transmission Line Structure Replacement	
Milford, NH	MAP SHEET
Date: March, 2021	12 OF 15



Known for excellence.
Built on trust.

GEOTECHNICAL
ENVIRONMENTAL
ECOLOGICAL
WATER
CONSTRUCTION
MANAGEMENT

5 Commerce Park North
Suite 201
Bedford, NH 03110
T: 603.623.3600
F: 603.624.9463
www.gza.com

An Equal Opportunity Employer M/F/V/H



March 9, 2021
File No. 04.0190999.39

NHDES Wetlands Bureau
29 Hazen Drive, P.O. Box 95
Concord, New Hampshire 03302

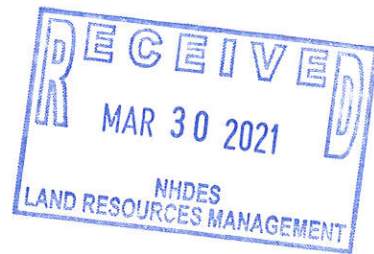

Re: Statutory Permit-by-Notification (SPN)
367 Right-of-Way (ROW)
Milford, New Hampshire

Dear Wetlands Inspector:

This letter transmits a Statutory Permit-by-Notification (SPN) application on behalf of Public Service Company of New Hampshire doing business as Eversource Energy (Eversource), for proposed ROW inspections work located within the existing and maintained 367 right-of-way (ROW). GZA GeoEnvironmental, Inc. (GZA) has been retained by Eversource Energy to pursue state permitting for ROW inspections within the 367 ROW which crosses through portions of Fitzwilliam, Rindge, New Ipswich, Greenville, Mason, Milford, Brookline, and Amherst, New Hampshire. Eversource Energy will be completing visual inspections of infrastructure within the ROWs. Access will typically occur along existing off-road vehicle trails in uplands to the greatest extent practicable. Work will be conducted according to the Best Management Practices Manual for Utility Management in and Adjacent to Wetlands and Waterbodies of New Hampshire (2019).

Pursuant to RSA 482-A:3; XV(d), Eversource is submitting a one-time annual fee of \$400 per town, in order to cover notifications during 2021.

Thank you for your review and please feel free to contact Conor Madison at (603) 232-8784 if you have any questions or comments.

Very truly yours,

GZA GEOENVIRONMENTAL, INC.

Conor Madison, CPESC, CESSWI
Scientist I

Tracy Tarr, CWS, CESSWI
Associate Principal

CEM/TLT

Attachments: Wetlands Statutory Permit-by-Notification (SPN)
Site Locus
Annotated Aerial Plan

cc: Jeremy Fennell, Eversource
Town of Milford, Town Clerk



**UTILITY MAINTENANCE ACTIVITY
STATUTORY PERMIT-BY-NOTIFICATION (SPN)
Water Division/Land Resources Management
Wetlands Bureau**



[Check the Status of your Notification](#)

RSA/Rule: RSA 482-A / Env-Wt 308.04(d); Env-Wt 521

NAME OF UTILITY PROVIDER: Eversource Energy

	Administrative Use Only	<input type="checkbox"/> SPN complete and project as described conforms with all applicable requirements.
		<input type="checkbox"/> SPN incomplete and/or project as described does not conform with all applicable requirements.
		File No.: <u>2021-00886</u> Reviewer's Initials:
		Check No.: <u>276183</u> Amount: <u>\$ 400.00</u>

Terms in **bold font** are defined in the attached "Definition of Terms" page.

SECTION 1 - PROJECT CRITERIA	
a. Does the project meet all applicable Best Management Practices for Utility Maintenance (<u>Utility BMPs</u>) and have temporary impacts associated with inspection, maintenance, repair, replacement, or removal of existing utility facilities only within existing rights-of-way (Env-Wt 521.06(a)(1))?	<input checked="" type="checkbox"/> Yes <input type="checkbox"/> No
b. If there will be impacts to any Priority Resource Area (PRA) , other than designated prime wetlands and their duly-established 100-foot buffers , will the project follow recommendations provided by Natural Heritage Bureau (NHB), New Hampshire Fish and Game Department (NHF&G), and the Department (Env-Wt 521.06(a)(4))?	<input checked="" type="checkbox"/> Yes <input type="checkbox"/> No <input type="checkbox"/> N/A
If you answered "No" to question 1a and/or 1b, you cannot use this form and must file a Standard Permit Application (RSA 482-A:3, XV). If you answered "Yes" to question 1a and 1b, proceed to question 1c.	
c. Will the project include establishing new access roads, installing permanent stream or wetland crossings, constructing new utility corridors or rights of way (ROW), or establishing new utility assets within existing corridors or rights of way (Env-Wt 521.06(a)(2))?	<input type="checkbox"/> Yes <input checked="" type="checkbox"/> No
d. Will the project include any permanent fill in navigable waters (Env-Wt 521.06(a)(3))?	<input type="checkbox"/> Yes <input checked="" type="checkbox"/> No
e. Will timber mats be:	
1. Used in a tidal marsh ; or	
2. Used in an area other than a tidal marsh if they are:	
• Not necessary to conduct activities;	<input type="checkbox"/> Yes <input checked="" type="checkbox"/> No
• Not removed as soon as work is completed; or	
• In place longer than one growing season (Env-Wt 521.06(a)(5))?	
f. Will the project cause permanent conversion of more than 3,000 SF of forested wetlands to emergent or scrub-shrub wetlands with or without temporary fill (Env-Wt 521.06(a)(6))?	<input type="checkbox"/> Yes <input checked="" type="checkbox"/> No
If you answered "Yes" to questions 1c, d, e, and/or f, you cannot use this form and must file a Standard Permit Application (RSA 482-A:3, XV). If you answered "No" to all of the questions 1c-1f, continue to Section 2.	

irm@des.nh.gov or (603) 271-2147
 NHDES Wetlands Bureau, 29 Hazen Drive, PO Box 95, Concord, NH 03302-0095
www.des.nh.gov

SECTION 2 - PROPOSED PROJECT DESCRIPTION (RSA 482-A:3, XV(b)(2))

Please provide a brief written description of the nature of the work to be conducted.

Eversource will be completing visual inspections of infrastructure within the ROWs. Access will typically occur along existing off-road vehicle trails in uplands to the greatest extent practicable. Work will be conducted according to the Best Management Practices Manual for Utility Management in and Adjacent to Wetlands and Waterbodies of New Hampshire (2019).

SECTION 3 - LOCATION OF PROPOSED ACTIVITY (RSA 482-A:3, XV(b)(3))

Town/City: Milford

SECTION 4 - PROJECT TYPE (RSA 482-A:3, XV(b)(2))

Check all that apply:

<input type="checkbox"/> Equipment repair and maintenance in ROW	<input type="checkbox"/> Natural Gas Lines
<input type="checkbox"/> Overhead Electric Lines	<input type="checkbox"/> Water Supply Lines
<input type="checkbox"/> Overhead Telephone or Cable Lines	<input type="checkbox"/> Sewer Lines
<input type="checkbox"/> Vegetative maintenance within ROW (If access through private property is needed to reach the ROW, permission from the landowner(s) is required prior to conducting work.)	<input checked="" type="checkbox"/> Other: ROW Inspections

SECTION 5 - UTILITY PROVIDER (RSA 482-A:3, XV(b)(1))

UTILITY PROVIDER/COMPANY NAME: Eversource Energy

AUTHORIZED REPRESENTATIVE LAST NAME, FIRST NAME, M.I.: Fennell, Jeremy

MAILING ADDRESS: 13 Legends Drive

TOWN/CITY: Hooksett

STATE: NH

ZIP CODE: 03106

SECTION 6 - IMPACTED RESOURCES (RSA 482-A:3, XV(b)(2))

Check all that apply.

<input checked="" type="checkbox"/> Temporary Non-Tidal Wetland
<input checked="" type="checkbox"/> Temporary Intermittent Stream Crossing
<input checked="" type="checkbox"/> Temporary (2-years maximum) Perennial Stream or River Crossing

SECTION 7 - ATTACHMENTS (RSA 482-A:3, XV)

Verify the following attachments are submitted with this form by checking each box below.

United States Geological Survey (USGS) Topographic Map (at its original scale 1:24,000 or 1:25,000) with the project location(s) or utility corridor clearly identified (RSA 482-A:3, XV(b)(3)).

irm@des.nh.gov or (603) 271-2147

NHDES Wetlands Bureau, 29 Hazen Drive, PO Box 95, Concord, NH 03302-0095

www.des.nh.gov

<input checked="" type="checkbox"/> The most recent National Wetland Inventory (NWI) map, USGS topographic map , or annotated aerial photograph showing wetland types crossed. See NHDES Wetland Permit Planning Tool (Env-Wt 406.03(b)(2)c.(5)).		
<input checked="" type="checkbox"/> \$400 non-refundable filing fee per town, per year. Please make check or money order payable to: Treasurer - State of NH (RSA 482-A:3, XV(d)).		
<input checked="" type="checkbox"/> The DataCheck identification number and an affirmation that recommendations have been received (Env-Wt 308.05(a)(2)). Natural Heritage Bureau Identification ID: NHB <u>20 - 194</u> <i>Questions related to completing this process should be directed to the Natural Heritage Bureau.</i>		
SECTION 8 - REQUIRED CERTIFICATIONS FROM AUTHORIZED UTILITY PROVIDER REPRESENTATIVE		
By initialing each item and signing this application, the authorized representative affirms that (Env-Wt 308.05(b)(2)):		
Initials: JF	The project is not located in a PRA, except as provided in Env-Wt 407 and Env-Wt 521 where the applicant has met with the resource agencies (NHB, NHF&G, and NHDES) in a pre-notice meeting.	
Initials: JF	All recommendations of NHB and NHF&G have been received. And	
Initials: JF	The person responsible for the activity is aware of the limits of the SPN and applicable BMPs for the project, and will adhere to both.	
By initialing each item and signing this application, the authorized representative certifies that (Env-Wt 311.11(e)):		
Initials: JF	The information submitted on or within this notification is true, complete, and not misleading to the best of the signer's knowledge and belief. And	
Initials: JF	The signer understands that: <ul style="list-style-type: none"> • The submission of false, incomplete, or misleading information constitutes grounds for NHDES to: <ol style="list-style-type: none"> 1. Deny the application. 2. Revoke any approval that is granted based on the information. And 3. If the signer is a certified wetland scientist, licensed surveyor, or professional engineer licensed to practice in New Hampshire, refer the matter to the joint board of licensure and certification established by RSA 310-A:1. • The signer is subject to the penalties specified in New Hampshire law for falsification in official matters, currently RSA 641. The signature shall constitute authorization for the municipal conservation commission and the Department to inspect the site of the proposed project. 	
SECTION 9 - REQUIRED SIGNATURE FROM AUTHORIZED UTILITY PROVIDER REPRESENTATIVE		
AUTHORIZED REPRESENTATIVE SIGNATURE: 	PRINT NAME LEGIBLY: Jeremy Fennell	DATE: 03/9/2021

C:\Users\j\OneDrive\Documents\GIS\2021\SPAT\Town\Milford\Locus.mxd, 12/18/2020, 9:55:28 AM, Logan Young

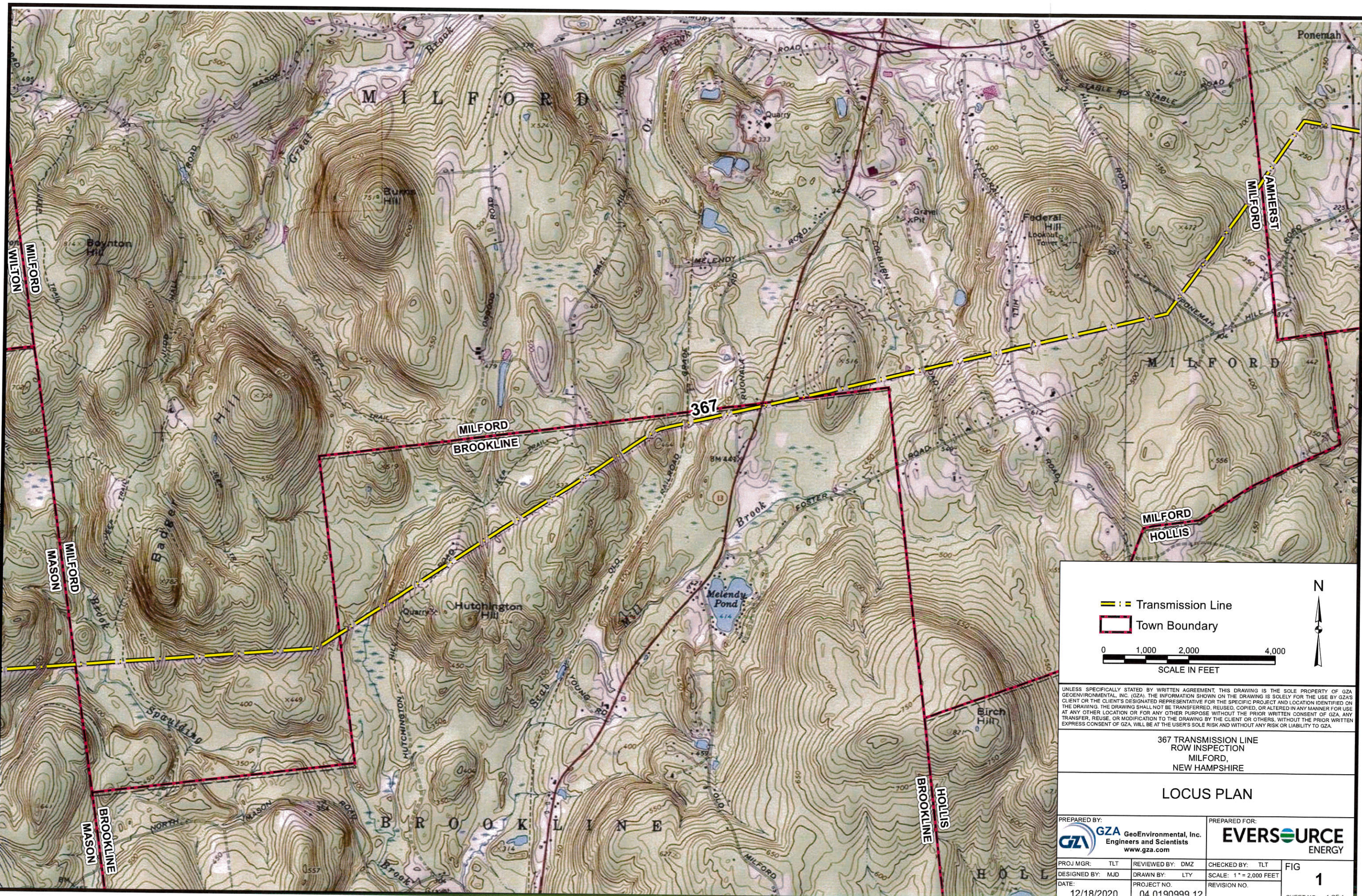

UNLESS SPECIFICALLY STATED BY WRITTEN AGREEMENT, THIS DRAWING IS THE SOLE PROPERTY OF GZA GEOENVIRONMENTAL, INC. (GZA). THE INFORMATION SHOWN ON THE DRAWING IS SOLELY FOR THE USE BY GZA'S CLIENT OR THE CLIENT'S DESIGNATED REPRESENTATIVE FOR THE SPECIFIC PROJECT AND LOCATION IDENTIFIED ON THE DRAWING. THE DRAWING SHALL NOT BE TRANSFERRED, REUSED, COPIED, OR ALTERED IN ANY MANNER FOR USE AT ANY OTHER LOCATION OR FOR ANY OTHER PURPOSE WITHOUT THE PRIOR WRITTEN CONSENT OF GZA. ANY TRANSFER, REUSE, OR MODIFICATION TO THE DRAWING BY THE CLIENT OR OTHERS, WITHOUT THE PRIOR WRITTEN EXPRESS CONSENT OF GZA, WILL BE AT THE USER'S SOLE RISK AND WITHOUT ANY RISK OR LIABILITY TO GZA.

367 TRANSMISSION LINE
ROW INSPECTION
MILFORD,
NEW HAMPSHIRE

LOCUS PLAN

PREPARED BY: GZA GeoEnvironmental, Inc.
 Engineers and Scientists
 www.gza.com

PREPARED FOR: EVERSOURCE ENERGY

PROJ MGR: TLT	REVIEWED BY: DMZ	CHECKED BY: TLT	FIG
DESIGNED BY: MJD	DRAWN BY: LTY	SCALE: 1" = 2,000 FEET	1
DATE: 12/18/2020	PROJECT NO: 04.0190999.12	REVISION NO.	SHEET NO. 1 OF 1