

10/19/2018 10:29 AM - sulligx - C:\Users\sulligx\appdata\local\temp\AcPublish\_18528\H14143309.dwg - LOCATION MAP 197-198 ES VER: 12/2016

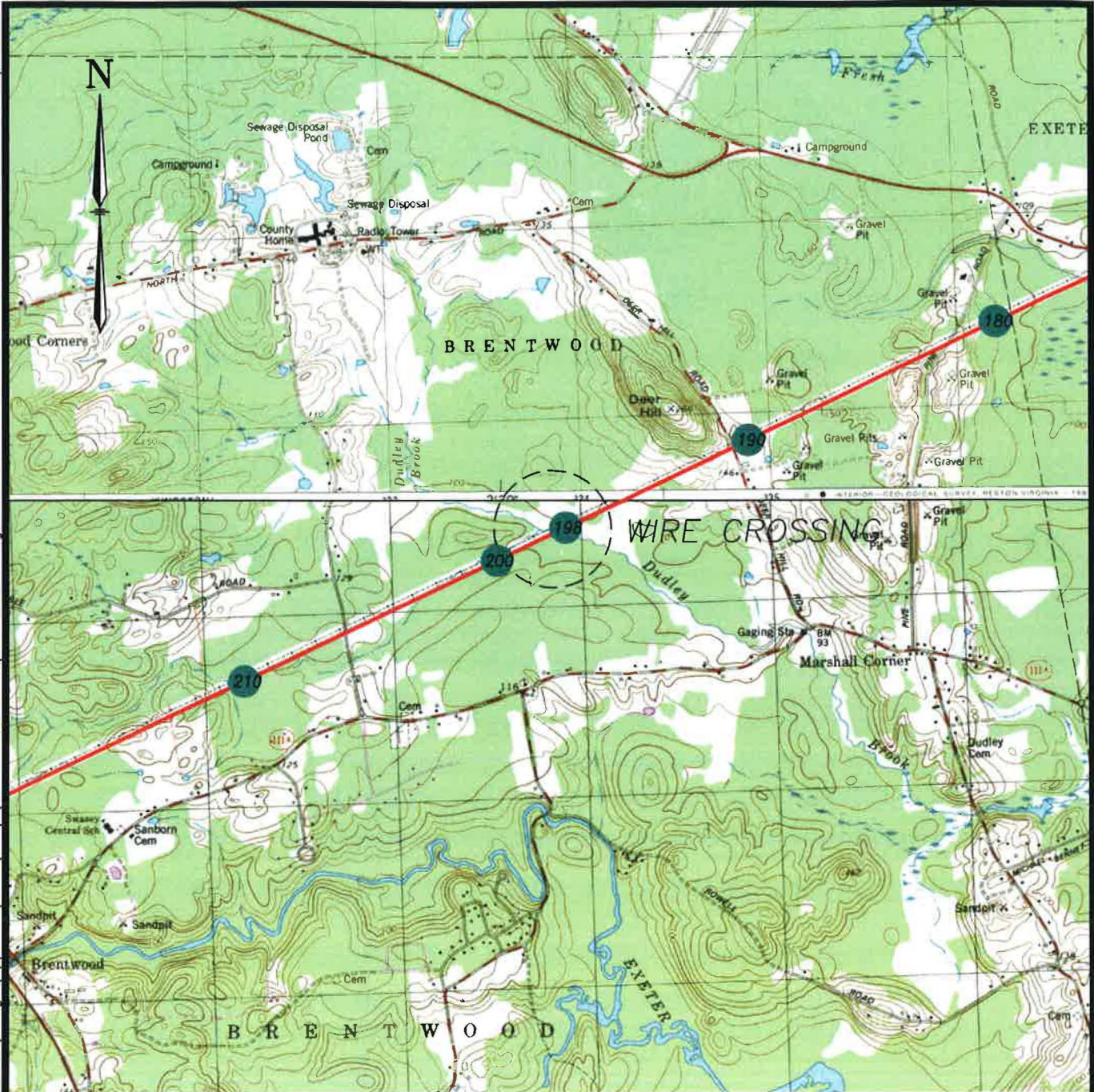

EXHIBIT 1

LEGEND:

H141 LINE ---  
 EXISTING H141 STR 198

**EVERSOURCE ENERGY**

LOCATION PLAN  
 H141 115 kV LINE, STR 197 TO 198  
 DUDLEY BROOK  
 BRENTWOOD, NEW HAMPSHIRE

|          |          |
|----------|----------|
| T        | 1        |
| DRAWN    | GBS      |
| ENGINEER | SDR      |
| CHECKED  | SDR      |
| APPROVED | DSD      |
| DATE     | 10/18/18 |

| 1       | ISSUED FOR CONSTRUCTION WO# TL9R8N01 | 10/18    | GBS  | JRS | DSD  |      |
|---------|--------------------------------------|----------|------|-----|------|------|
| DWG REV | EPN/DESCRIPTION                      | CONT/PE# | DATE | DRN | CHKD | APPR |

SCALE  
 1" = 2500'

FILE: H14143308.DWG  
 IMAGE:

DRAWING NO.  
**H14143309**

10/22/2018 10:00 AM - sulligx - C:\Users\sulligx\appdata\local\temp\AcPublish\_18528\A12643301.dwg - LOCATION MAP A126 221-222 ES VER: 12/2016

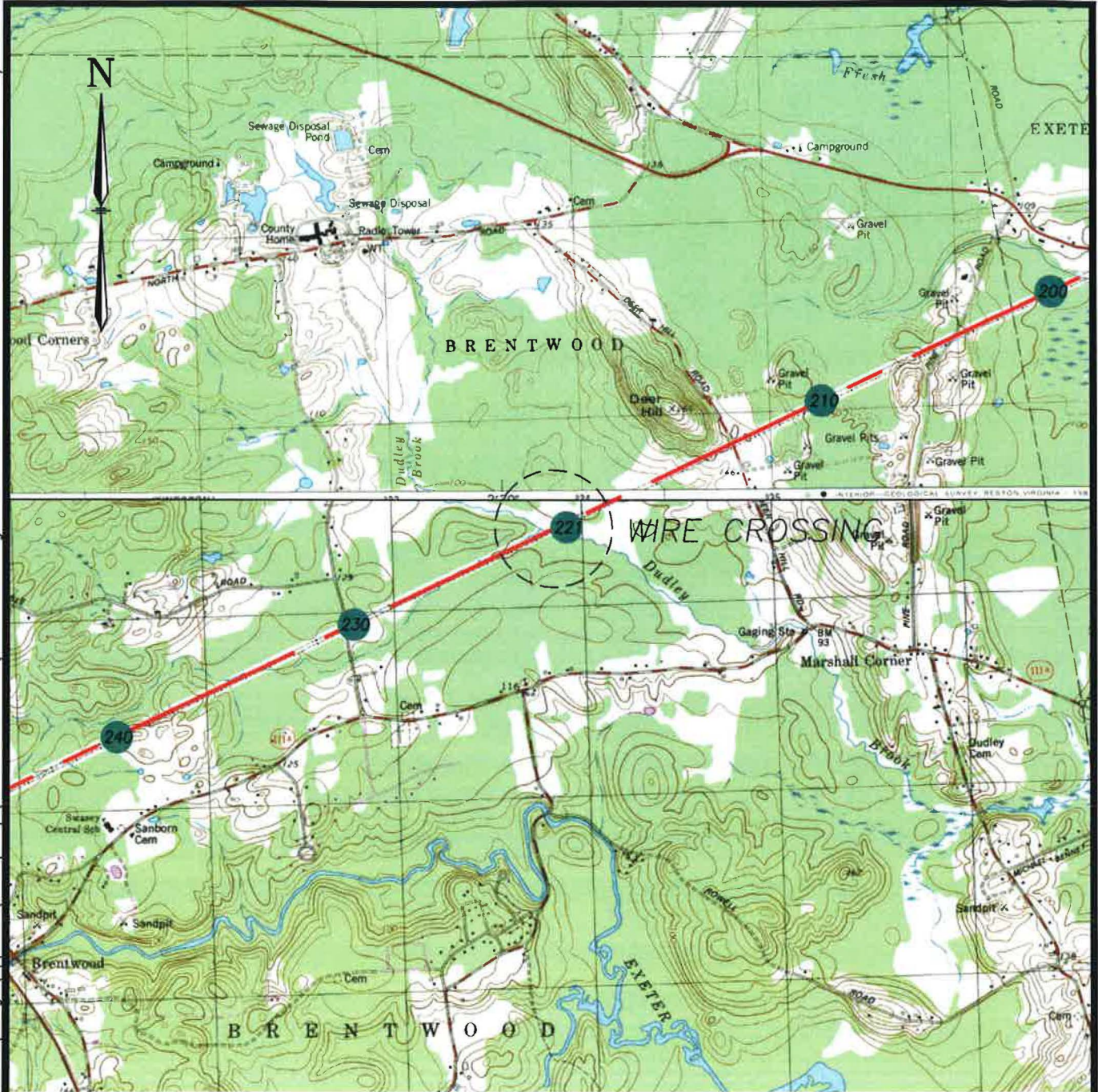

*EXHIBIT 1*

**LEGEND:**

A126 LINE   
 A126 STR 

**EVERSOURCE ENERGY**

LOCATION PLAN  
 A126 115 kV LINE, STR 221 TO 222  
 DUDLEY BROOK  
 BRENTWOOD, NEW HAMPSHIRE

|          |          |
|----------|----------|
| T        | 1        |
| DRAWN    | GBS      |
| ENGINEER | SDR      |
| CHECKED  | SDR      |
| APPROVED | DSD      |
| DATE     | 10/18/18 |

| DWG REV | EPN/DESCRIPTION                     | CONT/PE# | DATE  | DRN | CHKD | APPR |
|---------|-------------------------------------|----------|-------|-----|------|------|
| 1       | ISSUED FOR CONSTRUCTION WO TL9R&P01 |          | 10/18 | GBS | JRS  | DSD  |

SCALE 1" = 2500'  
 FILE: A12643301.DWG  
 IMAGE:

DRAWING NO. A12643301

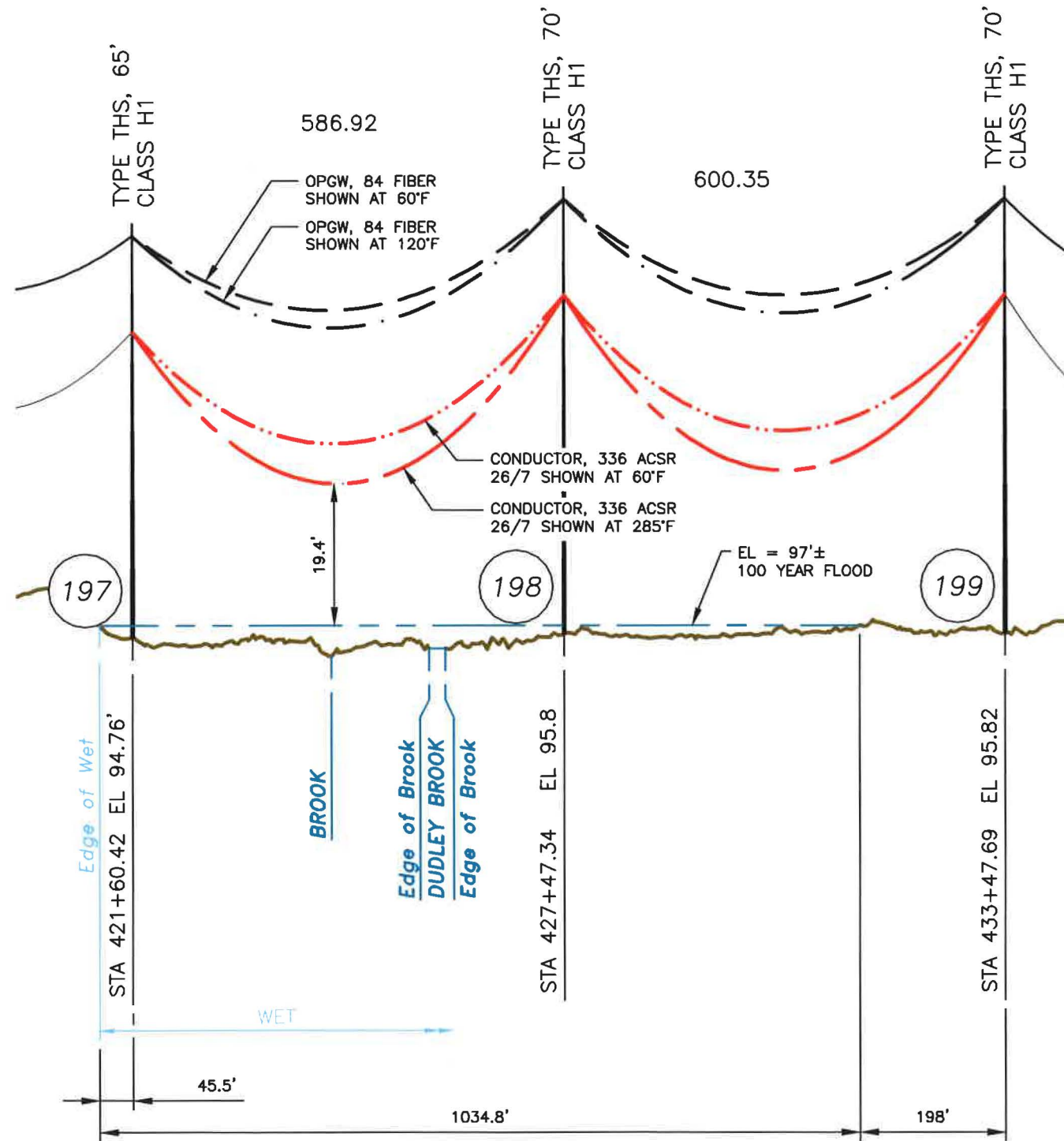

**PROFILE VIEW**

SCALE: HORZ 1" = 200'  
VERT 1" = 20'

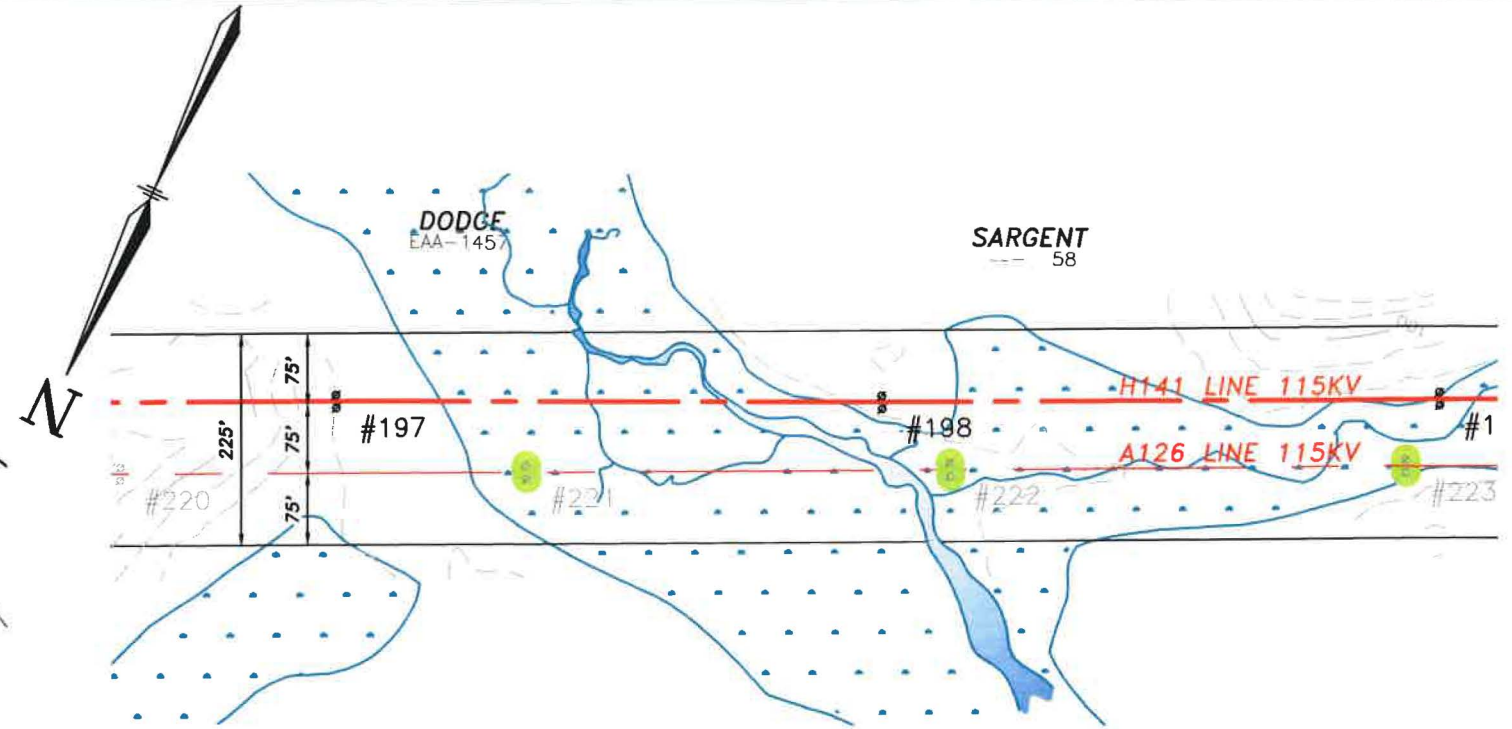

**PLAN VIEW**

SCALE: 1" = 200'

**LEGEND:**

- STATIC, OPGW, 84 FIBER
- — — — — SHOWN AT 60°F
- - - - - SHOWN AT 120°F
- 336 ACSR 26/7
- · - · - · - SHOWN AT 60°F
- - - - - SHOWN AT 285°F

**NOTES:**

1. ONLY LOWEST CONDUCTOR PHASE SHOWN FOR CLARITY.
2. ELEVATIONS REFERENCED TO THE NORTH AMERICAN VERTICAL DATUM OF 1988.

EXHIBIT 2

| DWG REV | EPN/DESCRIPTION                      | CONT/PE# | DATE  | DRN | CHKD | APPR |
|---------|--------------------------------------|----------|-------|-----|------|------|
| 1       | ISSUED FOR CONSTRUCTION WO# TL9RBN01 |          | 10/18 | GBS | JRS  | DSD  |

|  |  |          |          |
|--|--|----------|----------|
|  |  | T        | 1        |
|  |  | DRAWN    | GBS      |
| H141 115 kV TRANSMISSION LINE<br>BETWEEN STR 197 AND 198<br>DUDLEY BROOK<br>BRENTWOOD, NEW HAMPSHIRE |  | ENGINEER | SDR      |
|  |  | CHECKED  | SDR      |
| SCALE: 1" = 200'<br>FILE: H14143309.DWG<br>DRAWING NO. H14143309                                     |  | APPROVED | DSD      |
|  |  | DATE     | 10/18/18 |

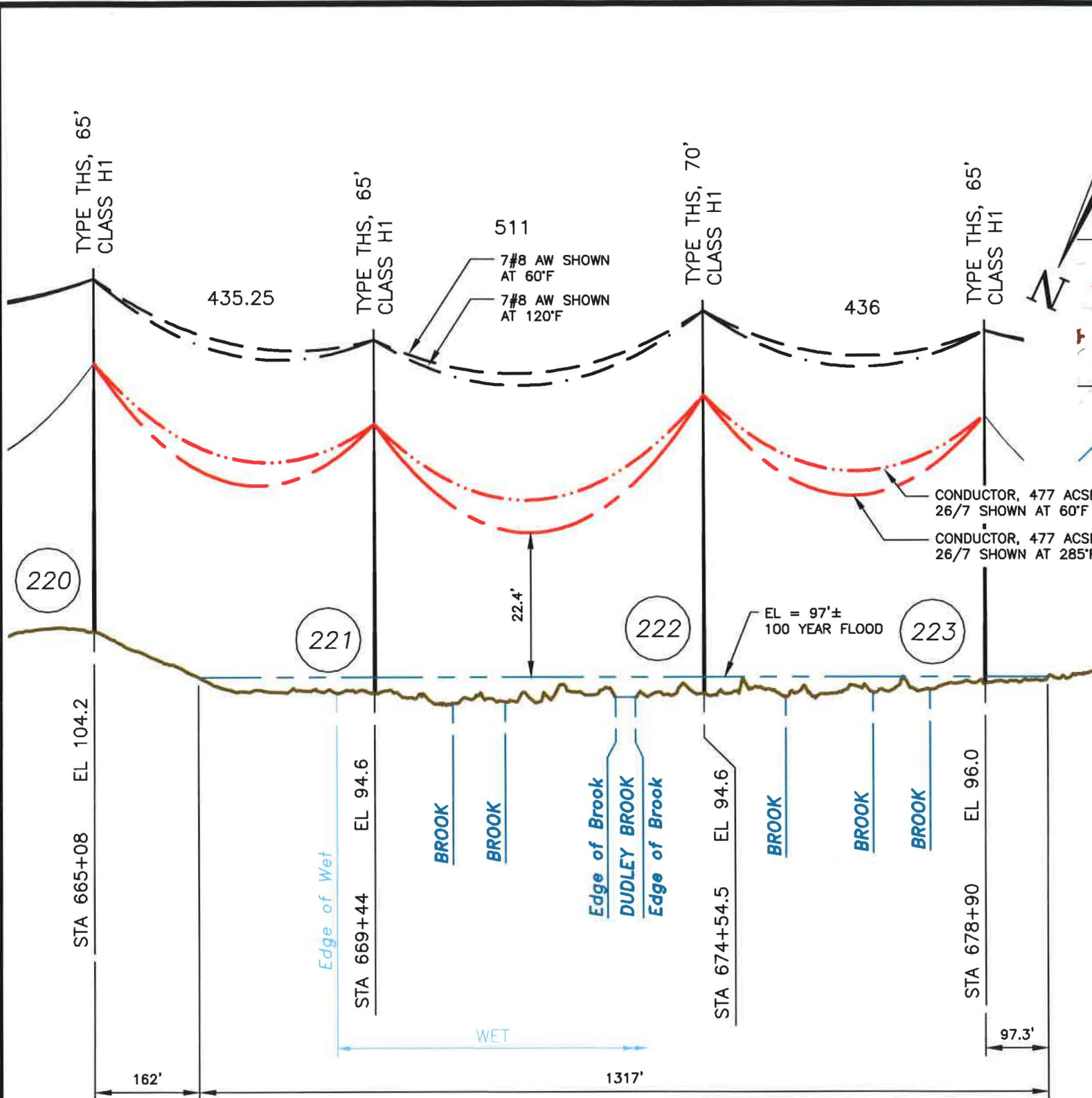

**PROFILE VIEW**

SCALE: HORZ 1" = 200'  
VERT 1" = 20'

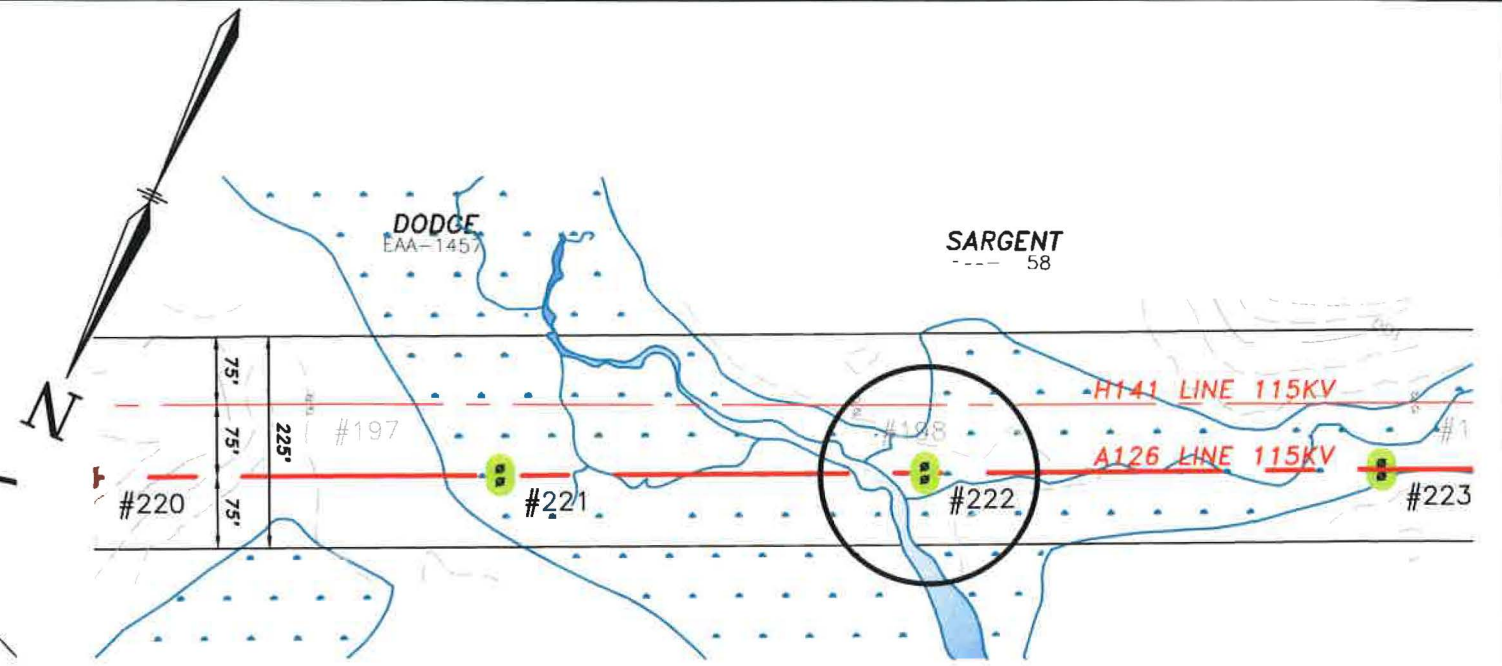

**PLAN VIEW**

SCALE: 1" = 200'

**LEGEND:**

- 7#8 ALUMOWELD
- — — SHOWN AT 60°F
- · — · — SHOWN AT 120°F
- 477 ACSR 26/7
- · — · — SHOWN AT 60°F
- · — · — SHOWN AT 285°F

**NOTES:**

1. ONLY LOWEST CONDUCTOR PHASE SHOWN FOR CLARITY.
2. ELEVATIONS REFERENCED TO THE NORTH AMERICAN VERTICAL DATUM OF 1988.

EXHIBIT 2

|  |  |          |          |
|--|--|----------|----------|
|  |  | T        | 1        |
|  |  | DRAWN    | GBS      |
| A126 115 kV TRANSMISSION LINE<br>BETWEEN STR 221 AND 222<br>DUDLEY BROOK<br>BRENTWOOD, NEW HAMPSHIRE |  | ENGINEER | SDR      |
|  |  | CHECKED  | SDR      |
| SCALE: 1" = 200'<br>FILE: A12643301.DWG<br>IMAGE:  |  | APPROVED | DSD      |
|  |  | DATE     | 10/18/18 |
| DRAWING NO.<br>A12643301   |  |          |          |

| DWG REV | EPN/DESCRIPTION                      | CONT/PE# | DATE  | DRN | CHKD | APPR |
|---------|--------------------------------------|----------|-------|-----|------|------|
| 1       | ISSUED FOR CONSTRUCTION WO# TL9R8P01 |          | 10/18 | GBS | JRS  | DSD  |