

Location Exhibits

1 - 4

© 2019 - GZA GeoEnvironmental, Inc. \GZA\Bedford\Jobs\04\Jobs\0190903\04\0190923_00 - Eversource MSA\04_0190923_11 - L176 Fiber - Wetland Permitting\Figures\MXD\DWG\Crossing TM 19 Lot 14a.mxd, 9/5/2019, 12:51:55 PM, lindsey.white

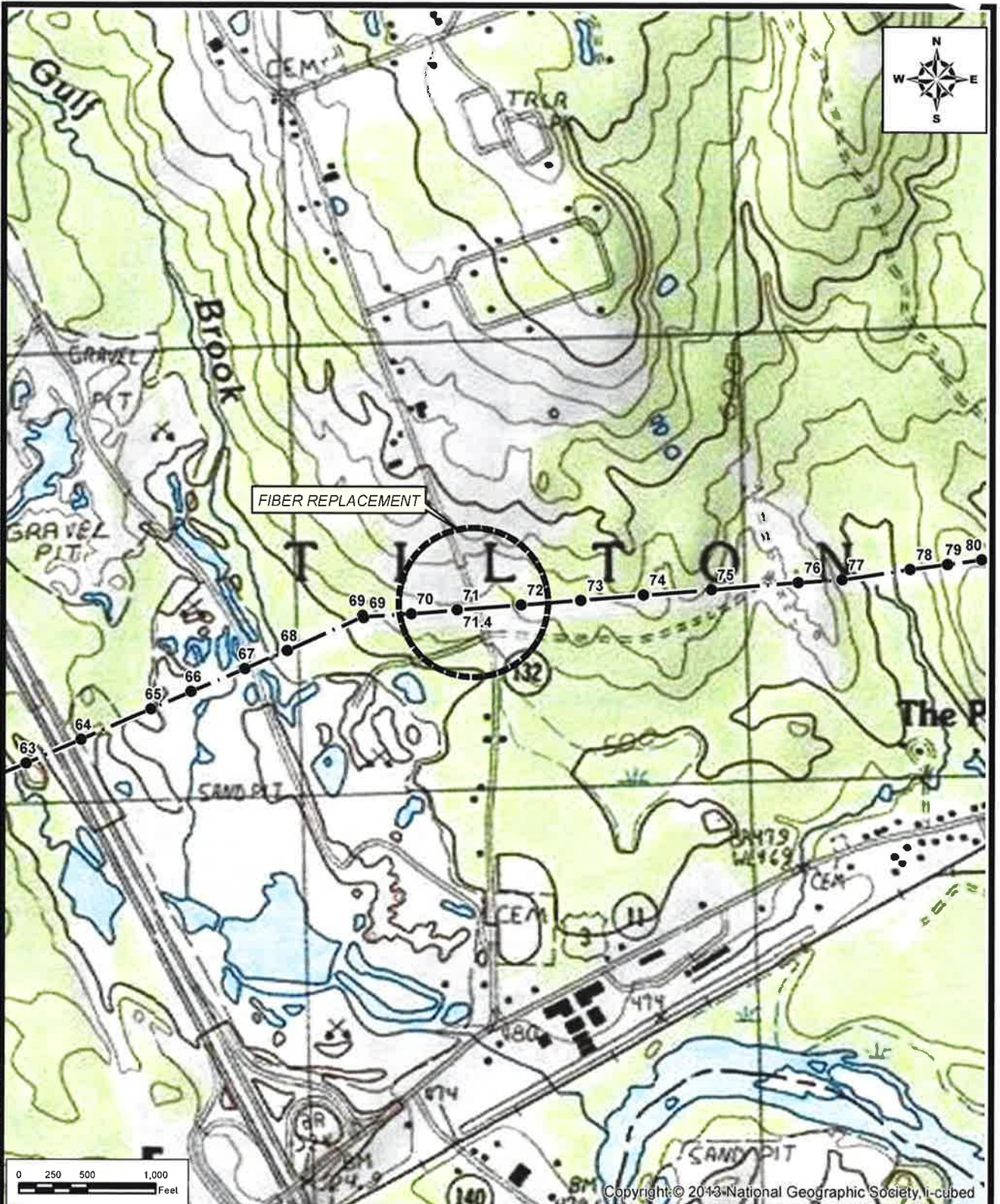

UNLESS SPECIFICALLY STATED BY WRITTEN AGREEMENT, THIS DRAWING IS THE SOLE PROPERTY OF GZA GEOENVIRONMENTAL, INC. (GZA). THE INFORMATION SHOWN ON THE DRAWING IS SOLELY FOR THE USE BY GZA'S CLIENT OR THE CLIENT'S DESIGNATED REPRESENTATIVE FOR THE SPECIFIC PROJECT AND LOCATION IDENTIFIED ON THE DRAWING. THE DRAWING SHALL NOT BE TRANSFERRED, REUSED, COPIED, OR ALTERED IN ANY MANNER FOR USE AT ANY OTHER LOCATION OR FOR ANY OTHER PURPOSE WITHOUT THE PRIOR WRITTEN CONSENT OF GZA. ANY TRANSFER, REUSE, OR MODIFICATION TO THE DRAWING BY THE CLIENT OR OTHERS, WITHOUT THE PRIOR WRITTEN EXPRESS CONSENT OF GZA, WILL BE AT THE USER'S SOLE RISK AND WITHOUT ANY RISK OR LIABILITY TO GZA.

L176 TRANSMISSION LINE FIBER REPLACEMENT PROJECT
 FRANKLIN, TILTON, BELMONT, & LACONIA,
 NEW HAMPSHIRE

PUBLIC UTILITIES COMMISSION LAND CROSSING UPDATE
 TAX MAP R19, LOT 14A
 ORDER NO. 26,181, DOCKET DE 18-081

NO.	ISSUE / DESCRIPTION	BY	DATE
PREPARED BY: GZA GeoEnvironmental, Inc. Engineers and Scientists www.gza.com		PREPARED FOR: 	
PROJ MGR: TLT	REVIEWED BY: TLT	CHECKED BY: DMZ	Exhibit 1
DESIGNED BY: LEW	DRAWN BY: LEW	SCALE: 1 in = 1,000 ft	
DATE: AUGUST 2019	PROJECT NO: 04.0190923.11	REVISION NO:	

Copyright © 2013 National Geographic Society, i-cubed

© 2019 - GZA GeoEnvironmental, Inc. \GZA\Bedford\Jobs\04_0190923_00 - Eversource MISA\04_0190923_11 - L176 Fiber - Wetland Permitting\Figures\MXD\IPUC Drawings\Land Crossing TM 490 Lot 303-5.mxd 8/5/2019 12:58:46 PM, lindsay.white

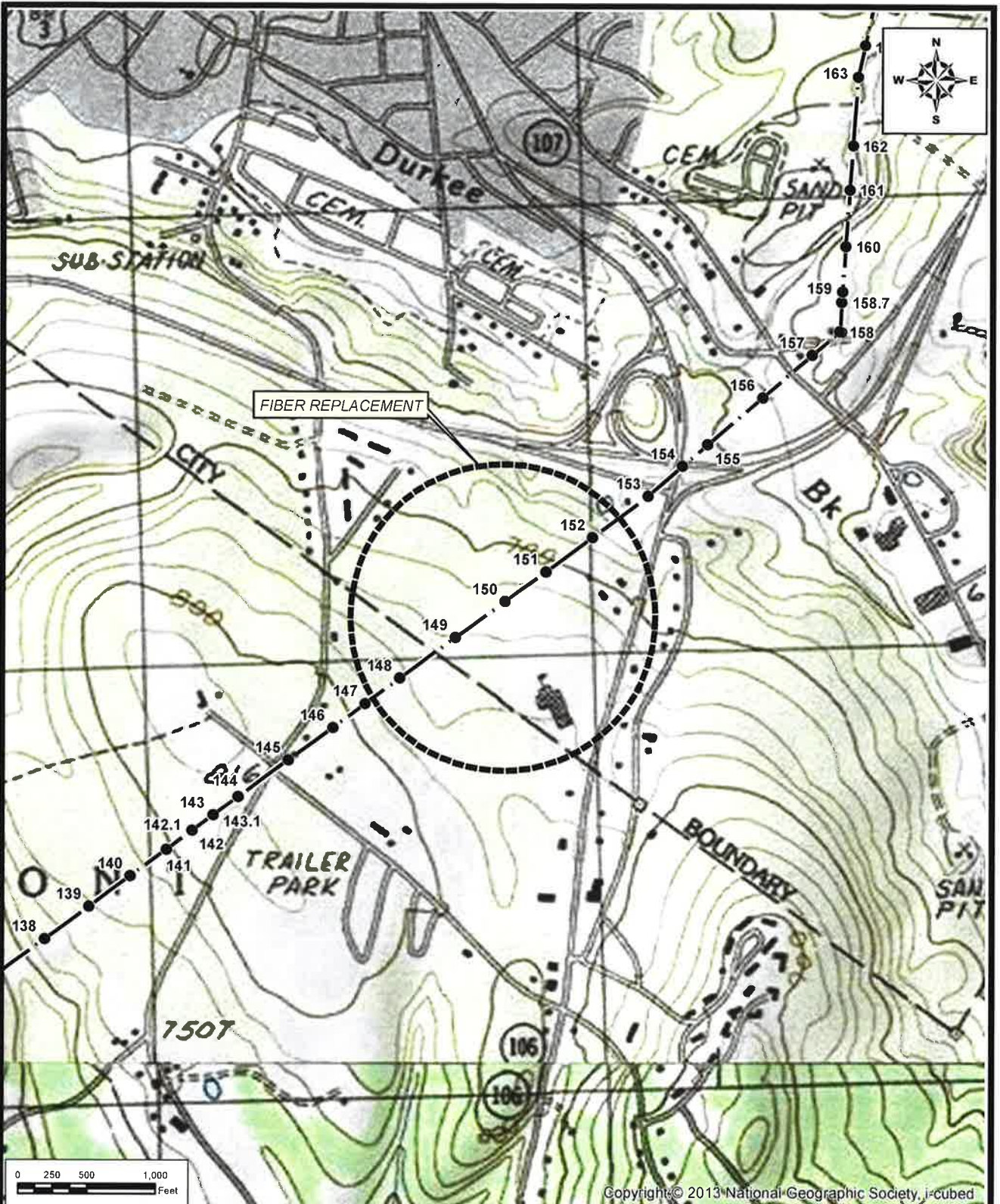

UNLESS SPECIFICALLY STATED BY WRITTEN AGREEMENT, THIS DRAWING IS THE SOLE PROPERTY OF GZA GEOENVIRONMENTAL, INC. (GZA). THE INFORMATION SHOWN ON THE DRAWING IS SOLELY FOR THE USE BY GZA'S CLIENT OR THE CLIENT'S DESIGNATED REPRESENTATIVE FOR THE SPECIFIC PROJECT AND LOCATION IDENTIFIED ON THE DRAWING. THE DRAWING SHALL NOT BE TRANSFERRED, REUSED, COPIED, OR ALTERED IN ANY MANNER FOR USE AT ANY OTHER LOCATION OR FOR ANY OTHER PURPOSE WITHOUT THE PRIOR WRITTEN CONSENT OF GZA. ANY TRANSFER, REUSE, OR MODIFICATION TO THE DRAWING BY THE CLIENT OR OTHERS, WITHOUT THE PRIOR WRITTEN EXPRESS CONSENT OF GZA, WILL BE AT THE USER'S SOLE RISK AND WITHOUT ANY RISK OR LIABILITY TO GZA.

L176 TRANSMISSION LINE FIBER REPLACEMENT PROJECT
FRANKLIN, TILTON, BELMONT, & LACONIA,
NEW HAMPSHIRE

PUBLIC UTILITIES COMMISSION LAND CROSSING UPDATE
TAX MAP 490, LOT 303-5
ORDER NO. 26,181, DOCKET DE 18-081

NO.	ISSUE / DESCRIPTION	BY	DATE
PREPARED BY:		PREPARED FOR:	
GZA GeoEnvironmental, Inc. Engineers and Scientists www.gza.com			
PROJ MGR: TLT	REVIEWED BY: TLT	CHECKED BY: DMZ	Exhibit 2
DESIGNED BY: LEW	DRAWN BY: LEW	SCALE: 1 in = 1,000 ft	
DATE: AUGUST 2019	PROJECT NO: 04.0190923.11	REVISION NO.	

© 2019 - GZA GeoEnvironmental, Inc. \\C:\ZABedford\Jobs\04_Lots\0190923_00 - Eversource_MSA\04_0190923_11 - L176 Fiber - Wetland Permitting\Figures\MXD\PUC Drawings\Land Crossing TM R21 Lot 06, Lot 07, TM 117, Lot 005.mxd, 8/5/2019, 1:01:45 PM, lindsay.wl

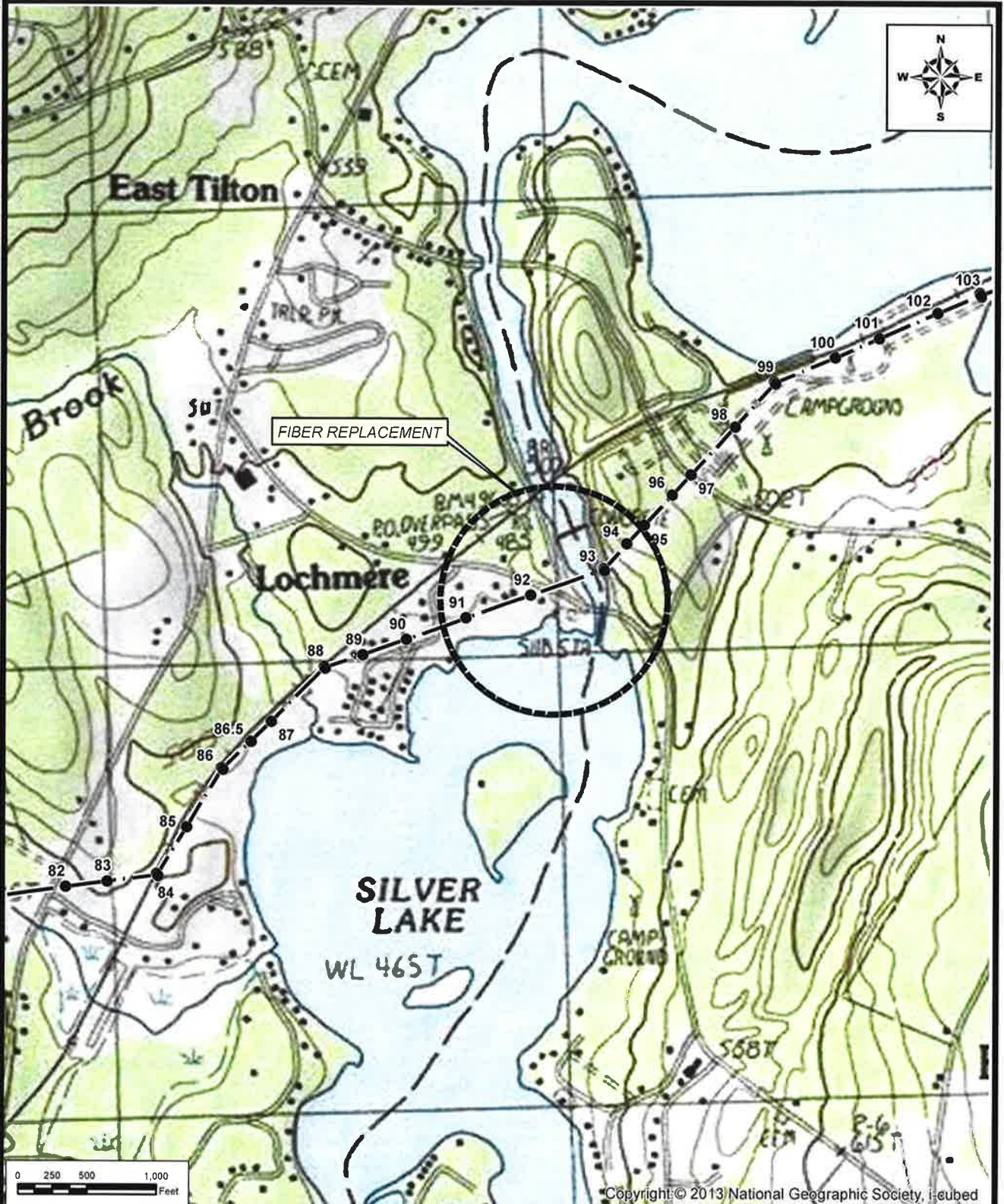

UNLESS SPECIFICALLY STATED BY WRITTEN AGREEMENT, THIS DRAWING IS THE SOLE PROPERTY OF GZA GEOENVIRONMENTAL, INC. (GZA). THE INFORMATION SHOWN ON THE DRAWING IS SOLELY FOR THE USE BY GZA'S CLIENT OR THE CLIENT'S DESIGNATED REPRESENTATIVE FOR THE SPECIFIC PROJECT AND LOCATION IDENTIFIED ON THE DRAWING. THE DRAWING SHALL NOT BE TRANSFERRED, REUSED, COPIED, OR ALTERED IN ANY MANNER FOR USE AT ANY OTHER LOCATION OR FOR ANY OTHER PURPOSE WITHOUT THE PRIOR WRITTEN CONSENT OF GZA. ANY TRANSFER, REUSE, OR MODIFICATION TO THE DRAWING BY THE CLIENT OR OTHERS, WITHOUT THE PRIOR WRITTEN EXPRESS CONSENT OF GZA, WILL BE AT THE USER'S SOLE RISK AND WITHOUT ANY RISK OR LIABILITY TO GZA.

L176 TRANSMISSION LINE FIBER REPLACEMENT PROJECT
 FRANKLIN, TILTON, BELMONT, & LACONIA,
 NEW HAMPSHIRE

PUBLIC UTILITIES COMMISSION LAND CROSSING UPDATE
 TAX MAP R21, LOTS 06 & 07, TAX MAP 117, LOT 005
 ORDER NO. 26,181, DOCKET DE 18-081

NO.		ISSUE / DESCRIPTION		BY	DATE
PREPARED BY:		GZA GeoEnvironmental, Inc. Engineers and Scientists www.gza.com		PREPARED FOR: EVERSOURCE ENERGY	
PROJ MGR:	TLT	REVIEWED BY:	TLT	CHECKED BY:	DMZ
DESIGNED BY:	LEW	DRAWN BY:	LEW	SCALE:	1 in = 1,000 ft
DATE:	AUGUST 2019	PROJECT NO:	04.0190923.11	REVISION NO:	

Exhibit 3

© 2019 - GZA GeoEnvironmental, Inc. \GZA\Beclford\Jobs\04_0190923_00 - Eversource_MSA\04_0190923_11 - L176 Fiber - Wetland Permittting\Figures\MXD\IPUC Drawings\st\Land Crossing TM U04 Lot 73.mxd, 8/5/2019, 1:03:09 PM, lindsay.white

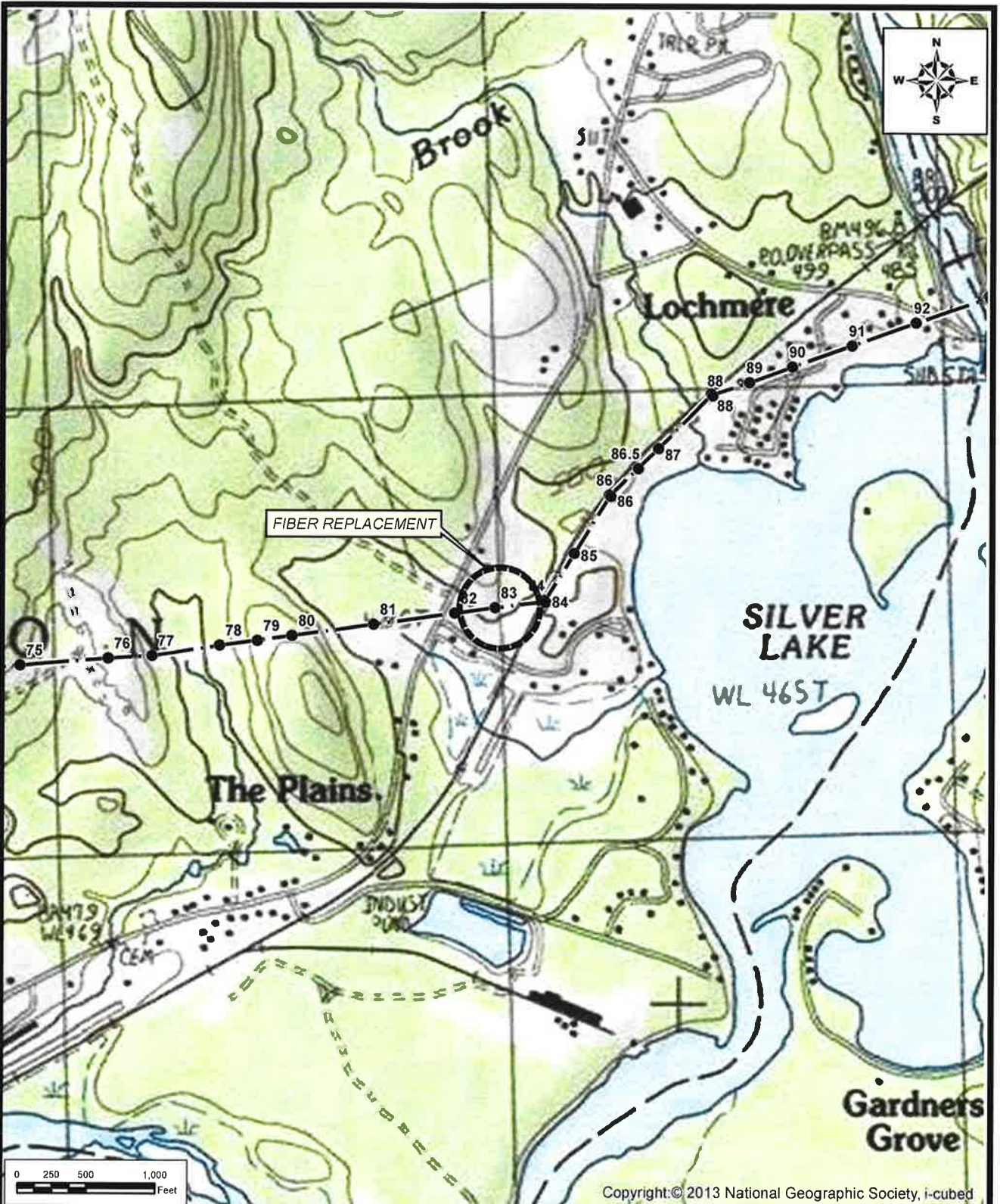

UNLESS SPECIFICALLY STATED BY WRITTEN AGREEMENT, THIS DRAWING IS THE SOLE PROPERTY OF GZA GEOENVIRONMENTAL, INC. (GZA). THE INFORMATION SHOWN ON THE DRAWING IS SOLELY FOR THE USE BY GZA'S CLIENT OR THE CLIENT'S DESIGNATED REPRESENTATIVE FOR THE SPECIFIC PROJECT AND LOCATION IDENTIFIED ON THE DRAWING. THE DRAWING SHALL NOT BE TRANSFERRED, REUSED, COPIED, OR ALTERED IN ANY MANNER FOR USE AT ANY OTHER LOCATION OR FOR ANY OTHER PURPOSE WITHOUT THE PRIOR WRITTEN CONSENT OF GZA. ANY TRANSFER, REUSE, OR MODIFICATION TO THE DRAWING BY THE CLIENT OR OTHERS, WITHOUT THE PRIOR WRITTEN EXPRESS CONSENT OF GZA, WILL BE AT THE USER'S SOLE RISK AND WITHOUT ANY RISK OR LIABILITY TO GZA.

L176 TRANSMISSION LINE FIBER REPLACEMENT PROJECT
FRANKLIN, TILTON, BELMONT, & LACONIA,
NEW HAMPSHIRE

PUBLIC UTILITIES COMMISSION LAND CROSSING UPDATE
TAX MAP U04, LOT 73 (RAILROAD)
ORDER NO. 26,181, DOCKET DE 18-081

NO.		ISSUE / DESCRIPTION		BY	DATE

PREPARED BY:	GZA GeoEnvironmental, Inc. Engineers and Scientists www.gza.com	PREPARED FOR:	EVERSOURCE ENERGY
PROJ MGR:	TLT	REVIEWED BY:	TLT
DESIGNED BY:	LEW	DRAWN BY:	LEW
DATE:	AUGUST 2019	PROJECT NO:	04.0190923.11
		CHECKED BY:	DMZ
		SCALE:	1 in = 1,000 ft
		REVISION NO:	

Exhibit 4

Engineer Details

Exhibits 5 – 9

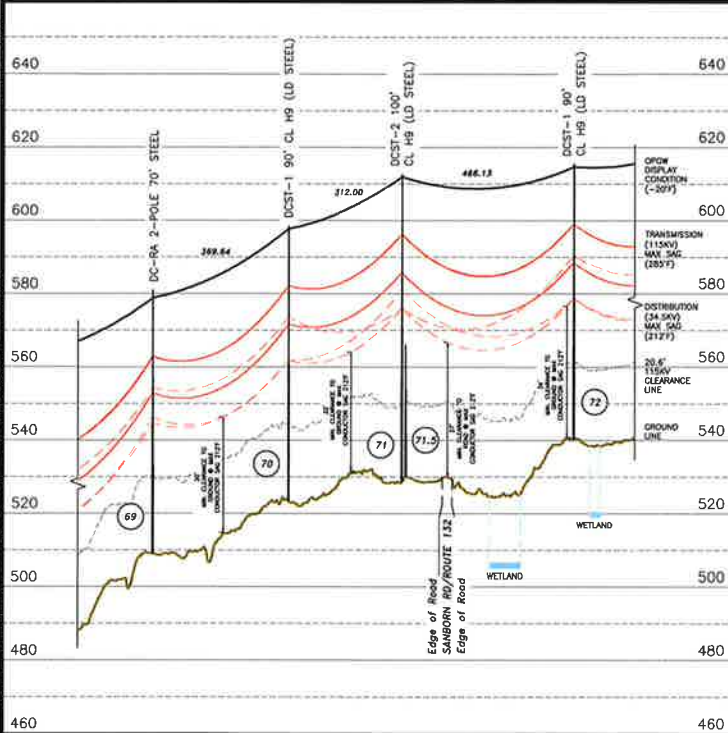

- NOTES:
1. VERTICAL DATUM IS NAVD83 IN FEET.
 2. COORDINATE SYSTEM IS NEW HAMPSHIRE STATE PLANE NAD 83 US SURVEY FEET.
 3. MAP NUMBERS REFER TO TOWN OF TILTON TAX IDENTIFICATION MAP NUMBERS WITH CORRESPONDING PARCEL IDENTIFICATION NUMBERS.

STRUCTURE LOCATION:
 STR. #69 - LAT. = 43°27'52.275"N
 LONG. = 71°34'7.818"W
 STR. #70 - LAT. = 43°27'52.502"N
 LONG. = 71°34'2.816"W
 STR. #71 - LAT. = 43°27'52.756"N
 LONG. = 71°33'58.599"W
 STR. #72 - LAT. = 43°27'53.126"N
 LONG. = 71°33'52.299"W

CABLE SCHEDULE:

WIRE	# OF CABLES	TYPE	DIA. (IN.)	WEIGHT/1000 FT	CABLE STRENGTH (LBS)
OPGW	1	0.646" OPGW (48F)	0.646	490.0	24,958
TRANSMISSION COND.	3	795 KCM 26/7 ACSR	1.108	1093.4	31,500
DISTRIBUTION COND.	3	477 KCM 26/7 ACSR	0.858	655.3	19,500

PROFILE LEGEND:
 - - - - - DISTRIBUTION WIRE
 ——— TRANSMISSION WIRE
 - - - - - 115KV CLEARANCE LINE
 ——— GROUND LINE PROFILE



NO	REV	DESCRIPTION	DATE	BY	CHKD	APPD
1		ISSUED FOR PERMIT	8/18/18	DAL	SAC	DEL
2		RE-ISSUED FOR PERMIT	12/22/18	JAR	SNV	CRP
3		ISSUED FOR PERMIT	12/22/18	HOW	BAF	DEL

EVERSOURCE ENERGY

LINE L176 115KV TRANSMISSION
 NH DOT CROSSING PERMIT DRAWING
 NHPUC CROSSING LICENSE

Exhibit 5

T	1
DESIGNED BY	JJD/TRC
CHECKED BY	CRP/TRC
ISSUED BY	BAF/TRC
APPROVED BY	DEL/TRC
DATE	9/28/17
DRAWING NO.	L17643702

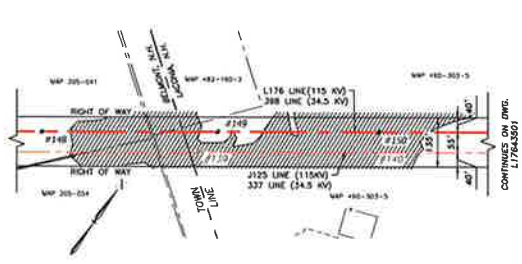
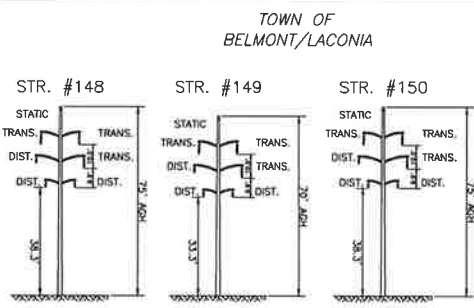
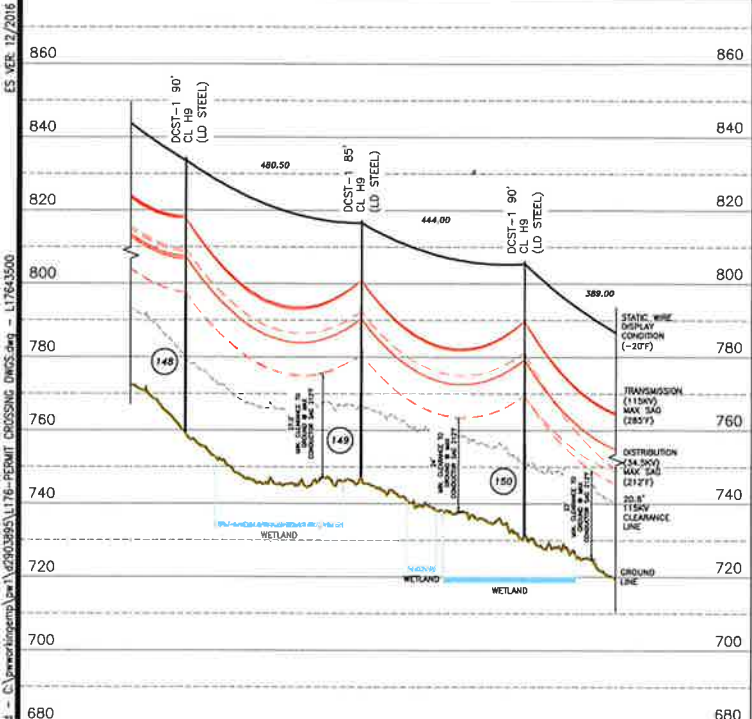

- NOTES:
1. VERTICAL DATUM IS NAVD88 IN FEET.
 2. COORDINATE SYSTEM IS NEW HAMPSHIRE STATE PLANE NAD 83 US SURVEY FEET.
 3. MAP NUMBERS REFER TO TOWN OF BELMONT/LACONIA TAX IDENTIFICATION MAP NUMBERS WITH CORRESPONDING PARCEL IDENTIFICATION NUMBERS.

STRUCTURE LOCATION:

STR. #148 - LAT.= 43°30'27.872"N
LONG.= 71°27'59.703"W

STR. #149 - LAT.= 43°30'30.676"N
LONG.= 71°27'54.442"W

STR. #150 - LAT.= 43°30'33.261"N
LONG.= 71°27'49.576"W

CABLE SCHEDULE:

WIRE	# OF CABLES	TYPE	DIA. (IN.)	WEIGHT/1000 FT.	CABLE STRENGTH (LBS.)
OPGW	1	0.646" OPGW (48F)	0.646	490.0	24,958
TRANSMISSION COND.	3	795 KCM 26/7 ACSR	1.108	1093.4	31,500
DISTRIBUTION COND.	3	477 KCM 26/7 ACSR	0.858	655.3	19,500

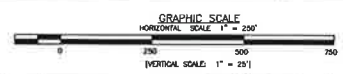

EVERSOURCE ENERGY

LINE L176 115KV TRANSMISSION
STATE OF NEW HAMPSHIRE
NHPUC CROSSING LICENSE

Exhibit 6

DATE	ISSUED FOR PERMIT	3/13/18	DES.	SAI	CEL
DATE	REVISED FOR PERMIT	5/22/18	AR	SMF	CRP
DATE	ISSUED FOR PERMIT	8/26/18	DES.	SAI	CEL
DATE	REVISED FOR PERMIT	10/22/18	AR	SMF	CRP

SCALE: 1" = 20'

PROJECT NO: L17643500

9/10/2019 1:17 PM - Susford - C:\pwworking\pwworking.com\Projects\176-PEPERMIT CROSSING DWG.dwg - L17643500

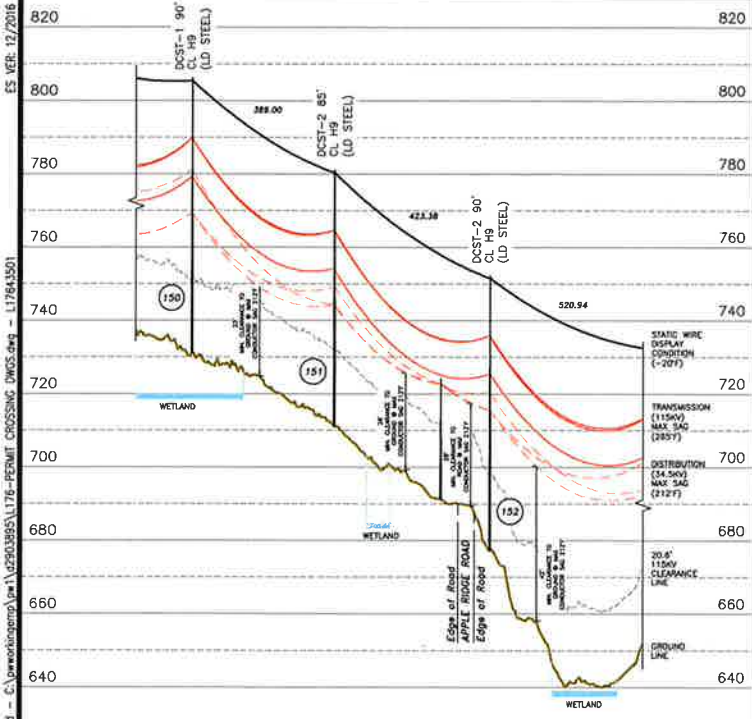

STRUCTURE LOCATION:
 STR. #150 - LAT.= 43°30'33.261"N
 LONG.= 71°27'49.576"W
 STR. #151 - LAT.= 43°30'35.52"N
 LONG.= 71°27'45.306"W
 STR. #152 - LAT.= 43°30'37.988"N
 LONG.= 71°27'40.668"W

CABLE SCHEDULE:

WIRE	# OF CABLES	TYPE	DIA. (IN.)	WEIGHT/1000 FT	CABLE STRENGTH (LBS.)
OPGW	1	0.648" OPGW (48F)	0.648	490.0	24,958
TRANSMISSION COND.	3	795 KCM 26/7 ACSR	1.108	1093.4	31,500
DISTRIBUTION COND.	3	477 KCM 26/7 ACSR	0.858	655.3	19,500

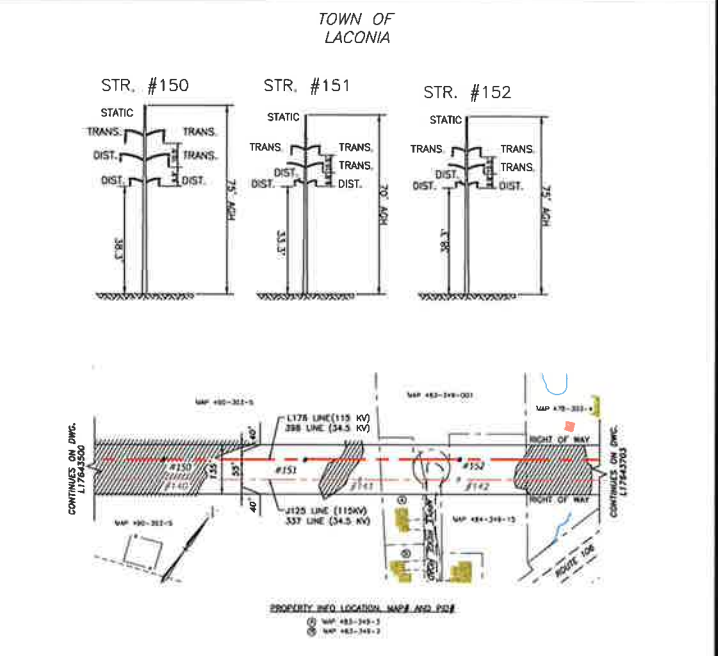

EVERSOURCE ENERGY

LINE L176 116KV TRANSMISSION
 STATE OF NEW HAMPSHIRE
 NHPUC CROSSING LICENSE

Exhibit 7

DATE	6/8/17
PROJECT NO.	L17643501

9/10/2019 1:17 PM - Successor - C:\www\info\comp\pwr\05903985\L176-PERMIT_CROSSING_LICENSE.dwg - L17643501 ES VER: 12/2016

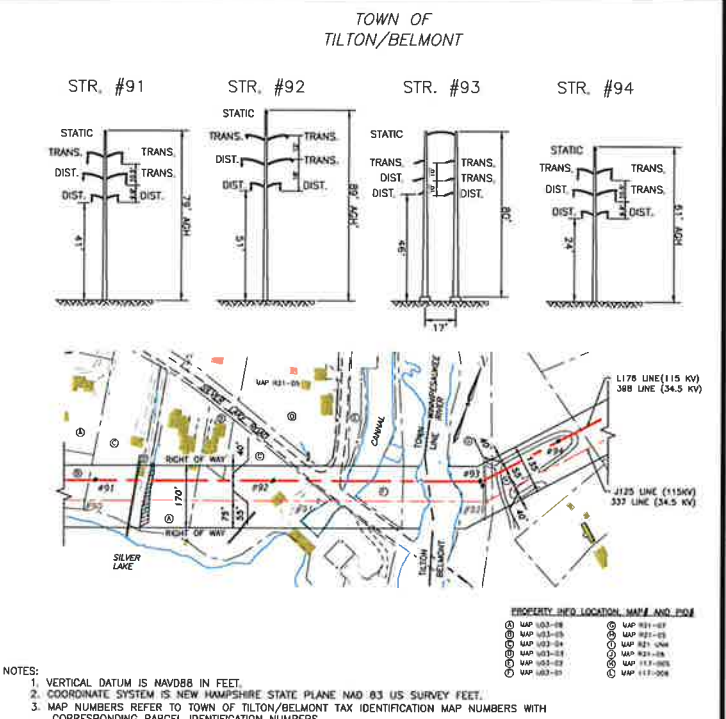
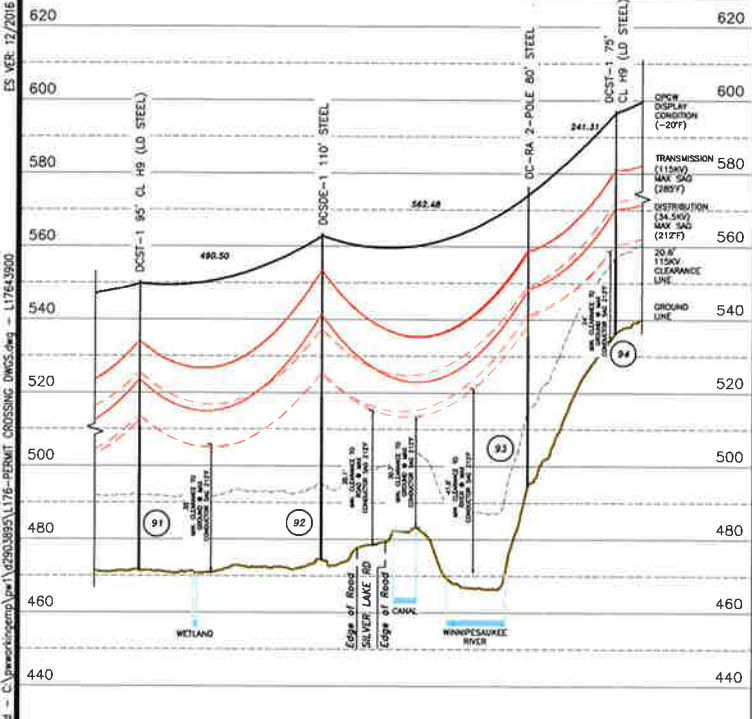

NOTES:
 1. VERTICAL DATUM IS NAVD88 IN FEET.
 2. COORDINATE SYSTEM IS NEW HAMPSHIRE STATE PLANE NAD 83 US SURVEY FEET.
 3. MAP NUMBERS REFER TO TOWN OF TILTON/BELMONT TAX IDENTIFICATION MAP NUMBERS WITH CORRESPONDING PARCEL IDENTIFICATION NUMBERS.

STRUCTURE LOCATION:
 STR. #91 - LAT = 43°28'17.394"N
 LONG. = 71°32'10.653"W
 STR. #92 - LAT = 43°28'19.011"N
 LONG. = 71°32'4.382"W
 STR. #93 - LAT = 43°28'20.847"N
 LONG. = 71°31'57.111"W
 STR. #94 - LAT = 43°28'22.631"N
 LONG. = 71°31'54.942"W

CABLE SCHEDULE:					
WIRE	# OF CABLES	TYPE	DIA. (IN.)	WEIGHT/1000 FT.	CABLE STRENGTH (LBS.)
OPGW	1	0.646" OPGW (48F)	0.646	490.0	24,958
TRANSMISSION COND.	3	795 KCM 26/7 ACSR	1.108	1093.4	31,500
DISTRIBUTION COND.	3	477 KCM 26/7 ACSR	0.858	655.3	19,500

PROFILE LEGEND:			
	STATIC WIRE		DISTRIBUTION WIRE
	TRANSMISSION WIRE		GROUND LINE PROFILE
			115KV CLEARANCE LINE



LINE L176 115KV TRANSMISSION
 NH DES WATER RESOURCES DIVISION
 NHPUC CROSSING LICENSE

<table border="1" style="width: 100%; border-collapse: collapse;"> <tr> <th>NO.</th> <th>ISSUED FOR PERMIT</th> <th>DATE</th> <th>BY</th> <th>CHKD.</th> <th>APP.</th> </tr> <tr> <td>1</td> <td>ISSUED FOR PERMIT</td> <td>8/18/17</td> <td>JAO</td> <td>BAF</td> <td>GEL</td> </tr> <tr> <td>2</td> <td>RE-ISSUED FOR PERMIT</td> <td>9/29/17</td> <td>JAO</td> <td>BAF</td> <td>CRP</td> </tr> <tr> <td>3</td> <td>ISSUED FOR PERMIT</td> <td>9/29/17</td> <td>JAO</td> <td>BAF</td> <td>GEL</td> </tr> <tr> <td>4</td> <td>REVISED FOR PERMIT</td> <td>11/17/17</td> <td>JAO</td> <td>BAF</td> <td>GEL</td> </tr> </table>	NO.	ISSUED FOR PERMIT	DATE	BY	CHKD.	APP.	1	ISSUED FOR PERMIT	8/18/17	JAO	BAF	GEL	2	RE-ISSUED FOR PERMIT	9/29/17	JAO	BAF	CRP	3	ISSUED FOR PERMIT	9/29/17	JAO	BAF	GEL	4	REVISED FOR PERMIT	11/17/17	JAO	BAF	GEL	<table border="1" style="width: 100%; border-collapse: collapse;"> <tr> <td style="text-align: center;">T</td> <td style="text-align: center;">1</td> </tr> <tr> <td style="text-align: center;">JAO/TRC</td> <td style="text-align: center;">DESIGNER</td> </tr> <tr> <td style="text-align: center;">BAF/TRC</td> <td style="text-align: center;">ENGINEER</td> </tr> <tr> <td style="text-align: center;">GEL/TRC</td> <td style="text-align: center;">CHECKER</td> </tr> <tr> <td style="text-align: center;">9/29/17</td> <td style="text-align: center;">DATE</td> </tr> <tr> <td style="text-align: center;">117643900</td> <td style="text-align: center;">PROJECT NO.</td> </tr> </table>	T	1	JAO/TRC	DESIGNER	BAF/TRC	ENGINEER	GEL/TRC	CHECKER	9/29/17	DATE	117643900	PROJECT NO.
NO.	ISSUED FOR PERMIT	DATE	BY	CHKD.	APP.																																						
1	ISSUED FOR PERMIT	8/18/17	JAO	BAF	GEL																																						
2	RE-ISSUED FOR PERMIT	9/29/17	JAO	BAF	CRP																																						
3	ISSUED FOR PERMIT	9/29/17	JAO	BAF	GEL																																						
4	REVISED FOR PERMIT	11/17/17	JAO	BAF	GEL																																						
T	1																																										
JAO/TRC	DESIGNER																																										
BAF/TRC	ENGINEER																																										
GEL/TRC	CHECKER																																										
9/29/17	DATE																																										
117643900	PROJECT NO.																																										

9/10/2019 1:17 PM - S:\esrc\proj\176-Permit-Crossing\176-Permit-Crossing DWG.dwg - L176-3900

Exhibit 8

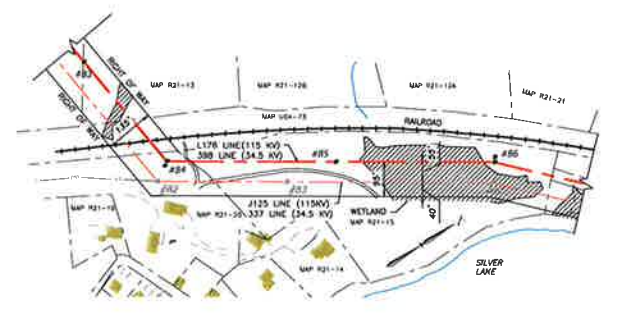
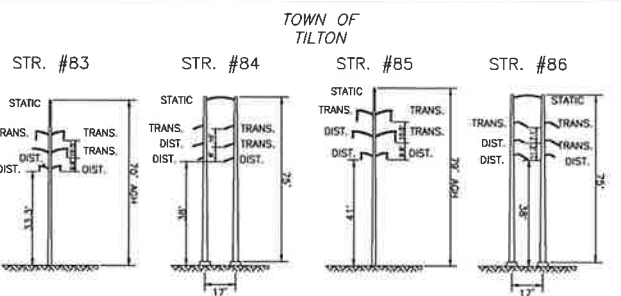
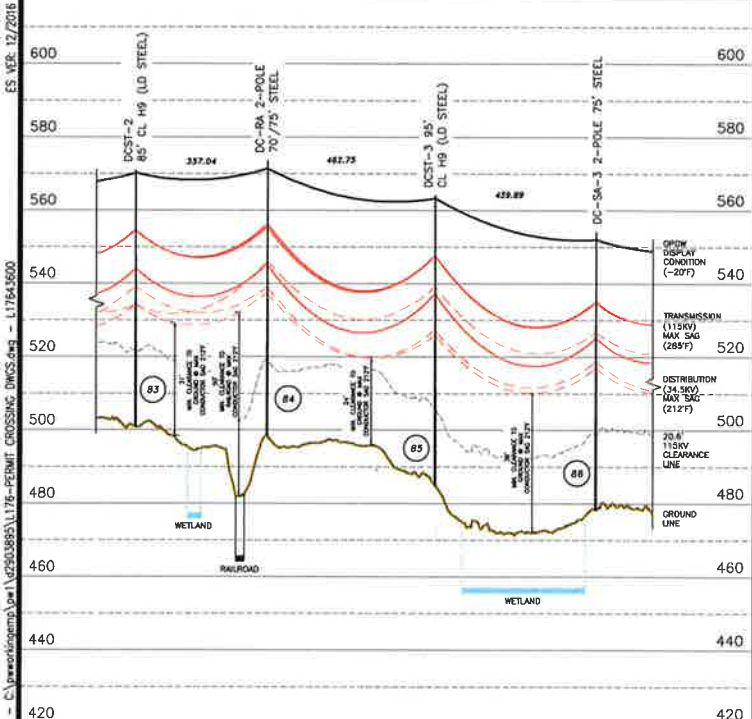

NOTES:
 1. VERTICAL DATUM IS NAVD88 IN FEET.
 2. COORDINATE SYSTEM IS NEW HAMPSHIRE STATE PLANE NAD 83 US SURVEY FEET.
 3. MAP NUMBERS REFER TO TOWN OF TILTON TAX IDENTIFICATION MAP NUMBERS WITH CORRESPONDING PARCEL IDENTIFICATION NUMBERS.

STRUCTURE LOCATION:

- STR. #83 - LAT. = 43°27'58.466"N
LONG. = 71°32'46.017"W
- STR. #84 - LAT. = 43°27'58.902"N
LONG. = 71°32'41.213"W
- STR. #85 - LAT. = 43°28'2.799"N
LONG. = 71°32'37.935"W
- STR. #86 - LAT. = 43°28'6.52"N
LONG. = 71°32'34.855"W

CABLE SCHEDULE:

WIRE	# OF CABLES	TYPE	DIA. (IN.)	WEIGHT/1000 FT	CABLE STRENGTH (LBS.)
OPGW	1	0.648" OPGW (48F)	0.648	490.0	24,958
TRANSMISSION COND.	3	795 KCM 26/7 ACSR	1.108	1093.4	31,500
DISTRIBUTION COND.	3	477 KCM 26/7 ACSR	0.858	655.3	19,500

PROFILE LEGEND:

—	STATIC WIRE	---	115KV CLEARANCE LINE
---	TRANSMISSION WIRE	---	GROUND LINE PROFILE
---	DISTRIBUTION WIRE	---	

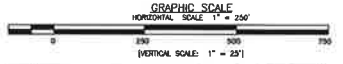

EVERSOURCE ENERGY

LINE L176 115KV TRANSMISSION
 NH BUREAU OF RAILROADS
 NHPUC CROSSING LICENSE

Exhibit 9

T	1
DATE	JUD/TRC
DESIGNED	CRP/TRC
CHECKED	RAF/TRC
APPROVED	GEL/TRC
DATE	9/29/17
PROJECT NO.	L17643600

9/19/2018 4:26 PM - S:\projects\p176-Permit\CROSSING_DWG.dwg - L17643600
 ES VER: 12/2016